



(D) Videounterstützte Montageanleitung

(TR) Video destekli kurulum talimatları

(RU) инструкция по монтажу с помощью видеосигнала

(RO) Instrucțiuni de instalare acceptate video

(GB) Video-assisted assembly instructions

(IT) Istruzioni di montaggio video-assistite

(CZ) Instalační pokyny podporované videem

(PL) Instrukcje montażu wspomagane sygnałem wizyjnym

(FR) Instructions de montage assistées par vidéo

(NL) Video-ondersteunde montage-instructies

(HU) Video-támogatott telepítési utasítások

(SK) Inštalčné pokyny podporované videom

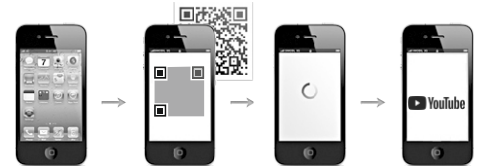
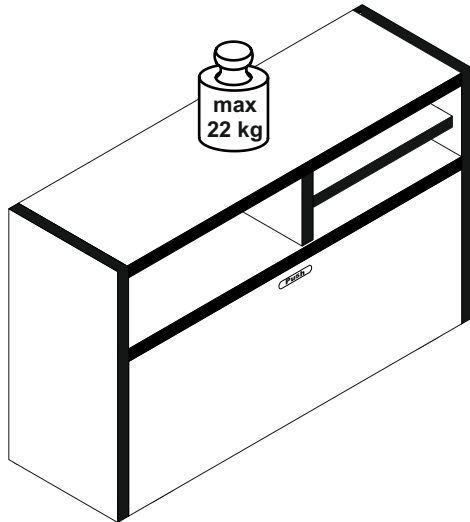

Art.-Nr.: **0221-HS_001**
Hängeschrank

REPC-Nr.:

Service • Assistenza • Dienstverlening • Serwis
Servis • Szerviz • Сервисная служба

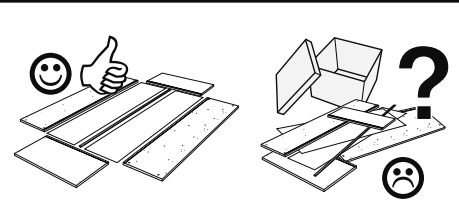
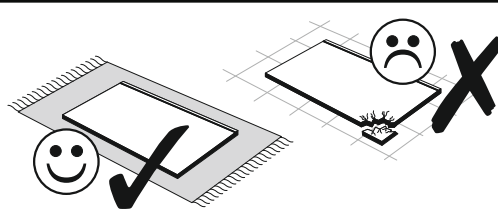
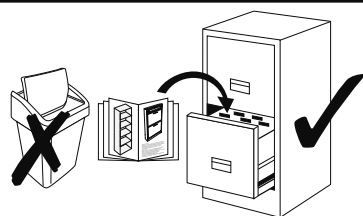
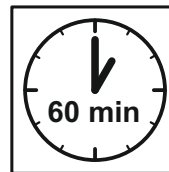
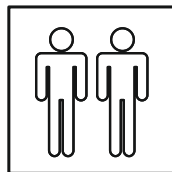
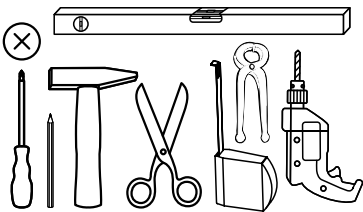

SCAN ME

Das Ersatzteil-Anforderungsformular finden Sie auf
The replacement parts requisition form you find on
<https://www.maeusbacher.de/ersatzteile/>

BT1-00281 Colli 1/1

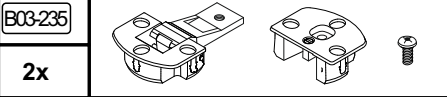

▶ SCAN ME

BT1-00280 Colli 1/1

| | | | | | | | |
|---------|--------|---------|-------|---------|--------|--------|--------|
| B01-30 | | B01-65 | | B01-200 | | B01-90 | |
| 16x | 3x16 | 13x | 3x13 | 2x | 6,3x13 | 4x | 3,5x20 |
| B01-120 | | B01-330 | | B02-10 | | B02-20 | |
| 2x | 3,5x45 | 8x | M4x10 | 14x | | 14x | |
| B02-160 | | B02-103 | | B08-40 | | B08-70 | |
| 4x | | 4x | 8x30 | 2x | 5,8x65 | 2x | Ø8 |
| | | | | | | B08-80 | |
| | | | | | | 1x | |

BT1-00282 Colli 1/1

| | | | | | | | | | | |
|---------|----|---------|--|---------|--|---------|--|---------|--|------|
| B01-351 | | B03-148 | | B03-149 | | B03-150 | | B03-157 | | Push |
| 8x | M4 | 1x | | 1x | | 1x | | 1x | | |
| B05-130 | | B05-185 | | | | | | | | |
| 1x | | 4x | | | | | | | | |

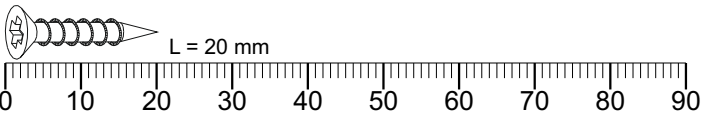

Colli 1/1

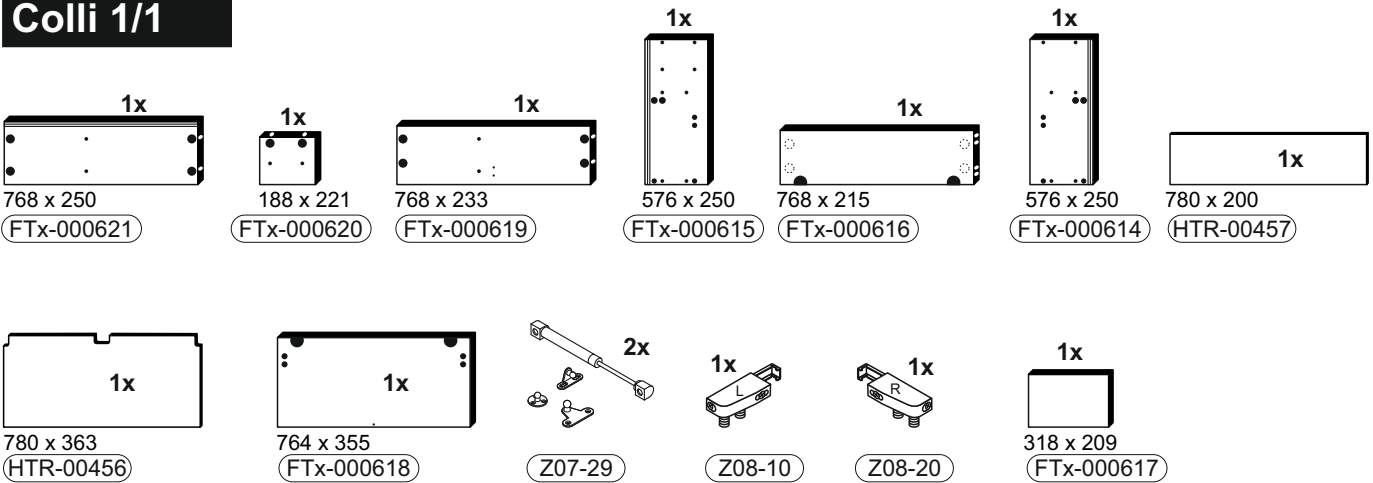

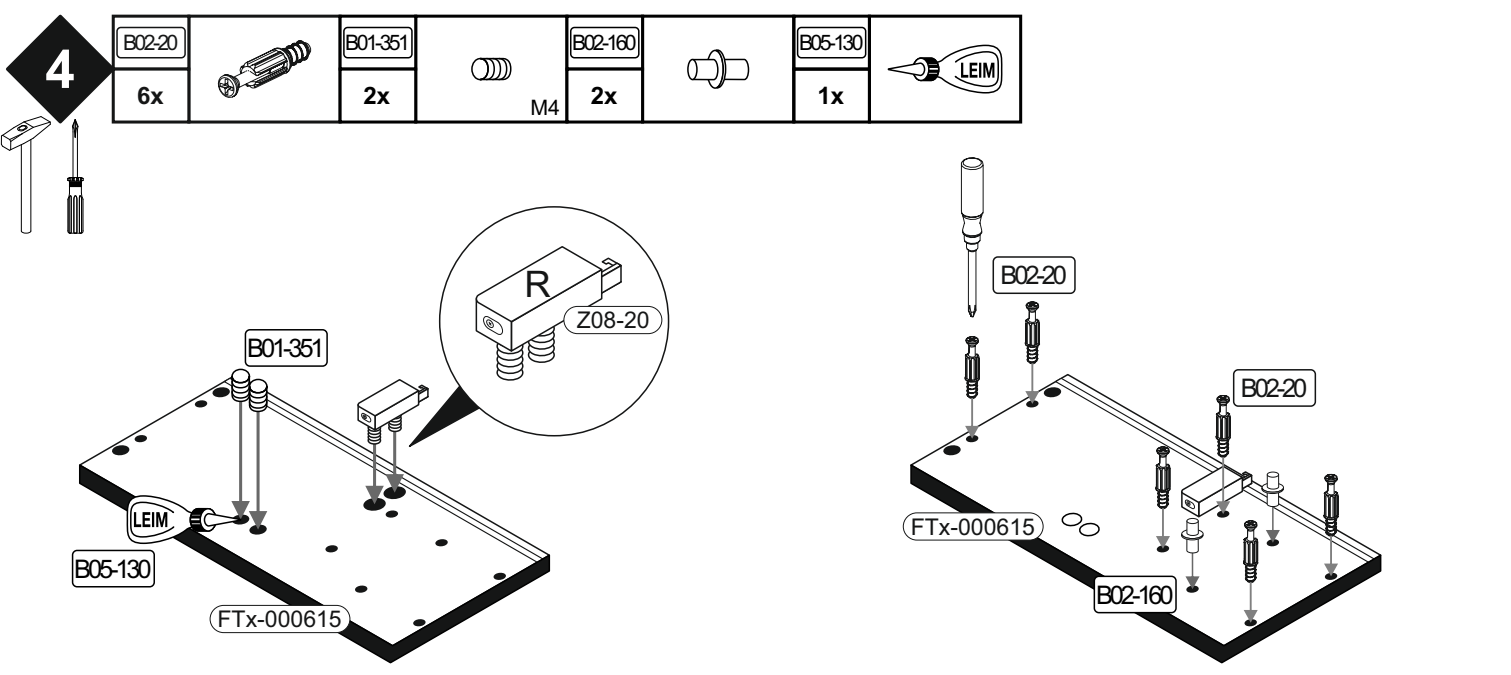
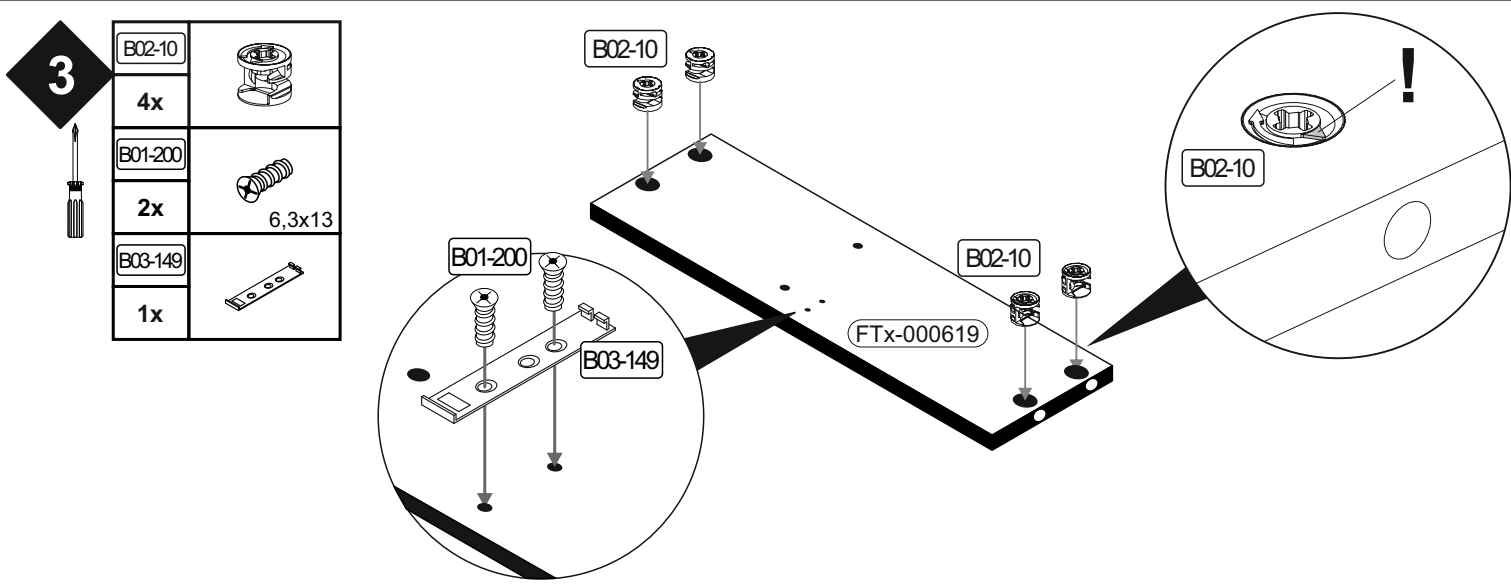
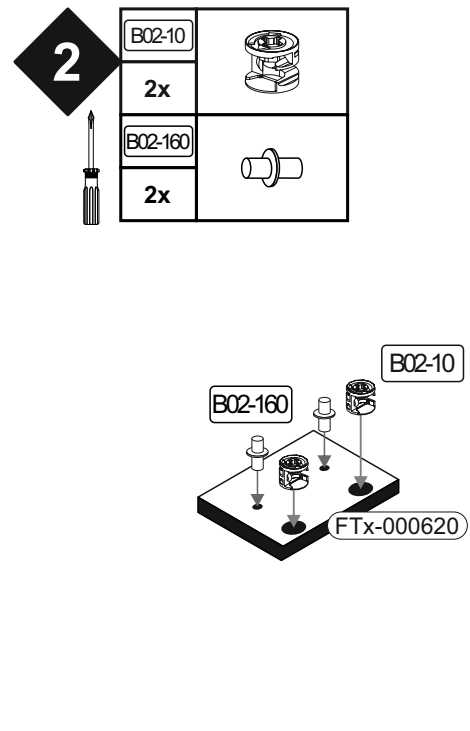
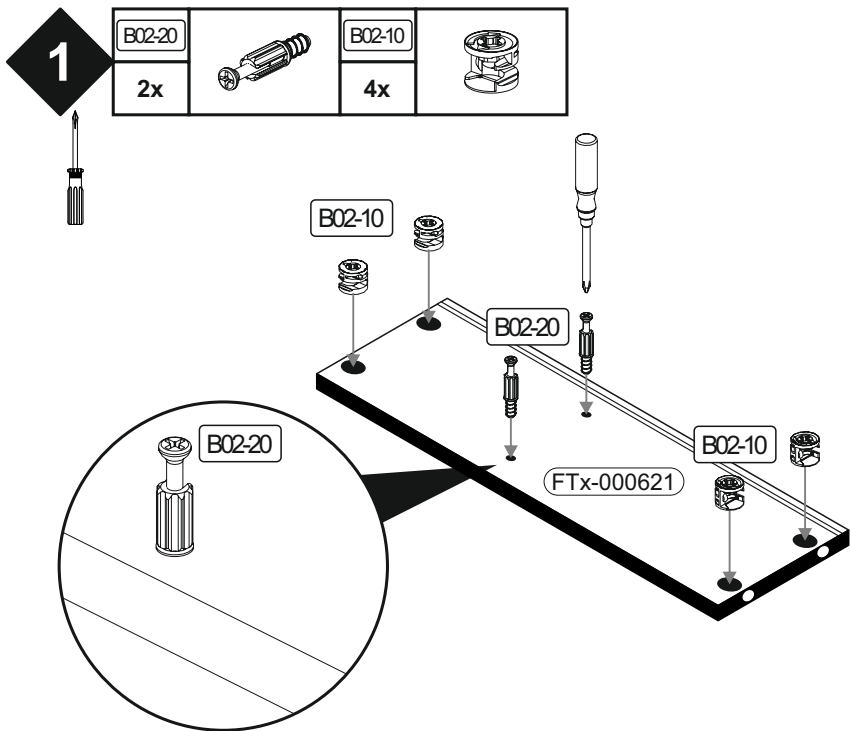

| | | | | | | |
|----------|--------|--|---------|----|---------|--|
| 5 | B02-20 | | B01-351 | | B05-130 | |
| | 6x | | 2x | M4 | 1x | |

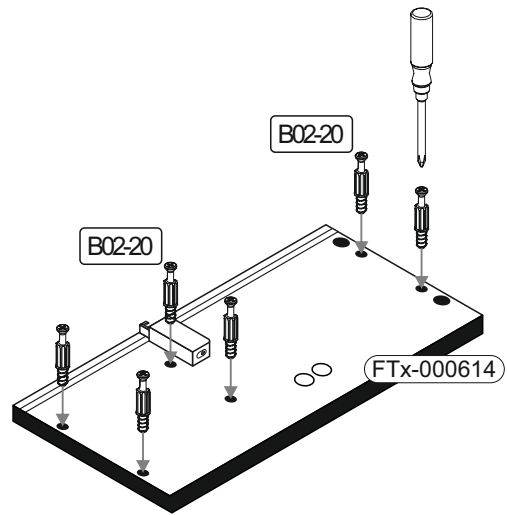
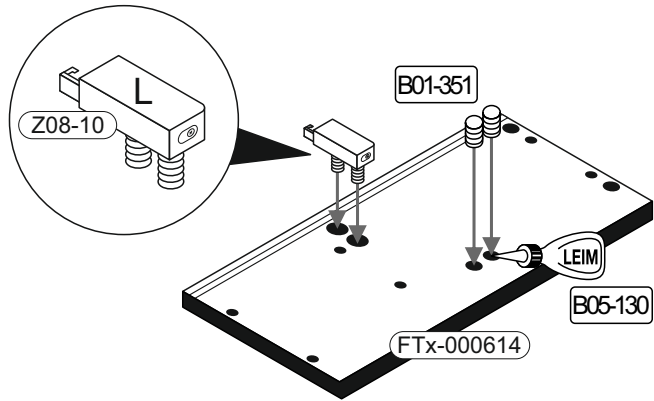
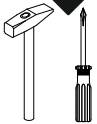

| | | | | | | | | | | |
|----------|--------|--|---------|--|--------|------|---------|--|---------|------|
| 6 | B02-10 | | B03-235 | | B01-65 | | B05-130 | | B02-103 | |
| | 4x | | 2x | | 6x | 3x13 | 1x | | 4x | 8x30 |

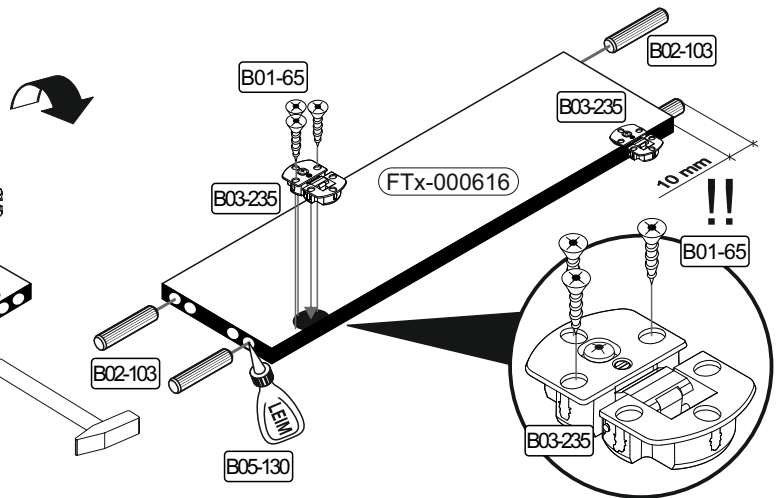
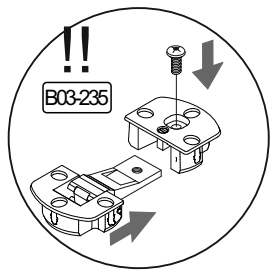
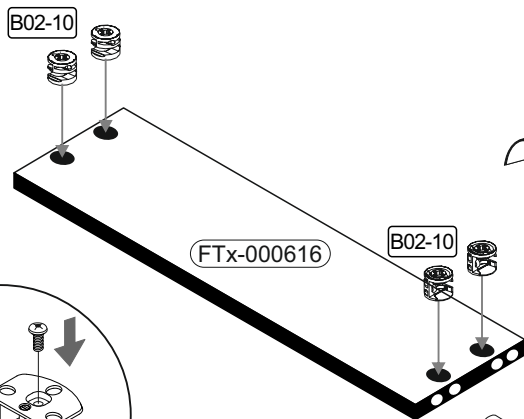
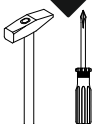

| | | |
|----------|---------|------|
| 7 | B01-351 | |
| | 4x | M4 |
| | B03-150 | |
| | 1x | |
| | B01-65 | |
| | 1x | 3x13 |
| B05-130 | | |
| 1x | | |

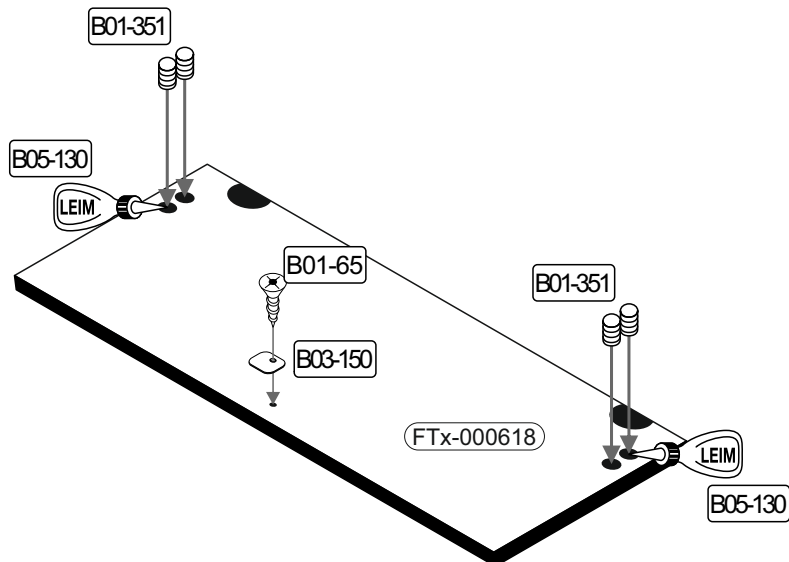
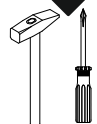

8

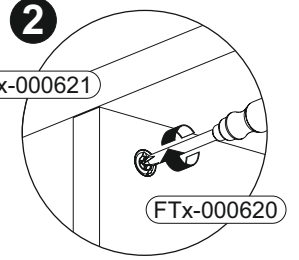
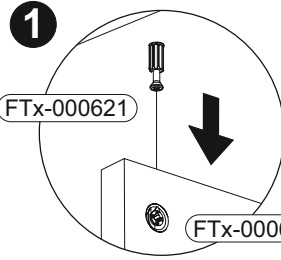
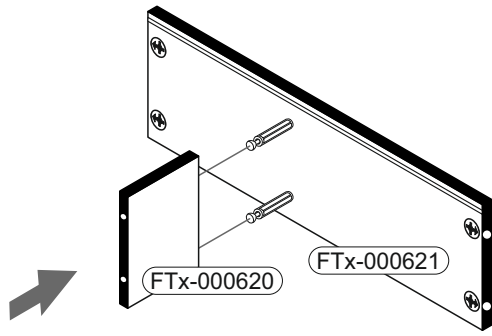

9

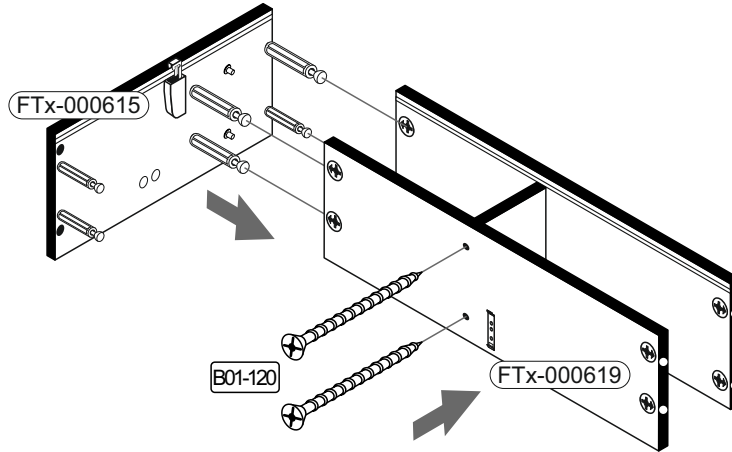
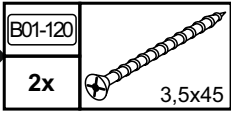

10

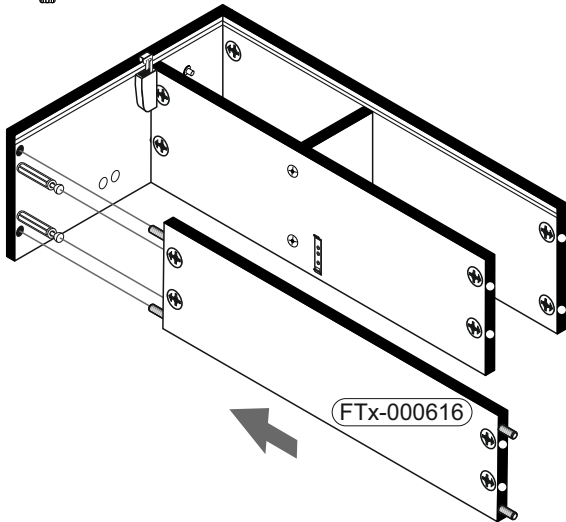

11

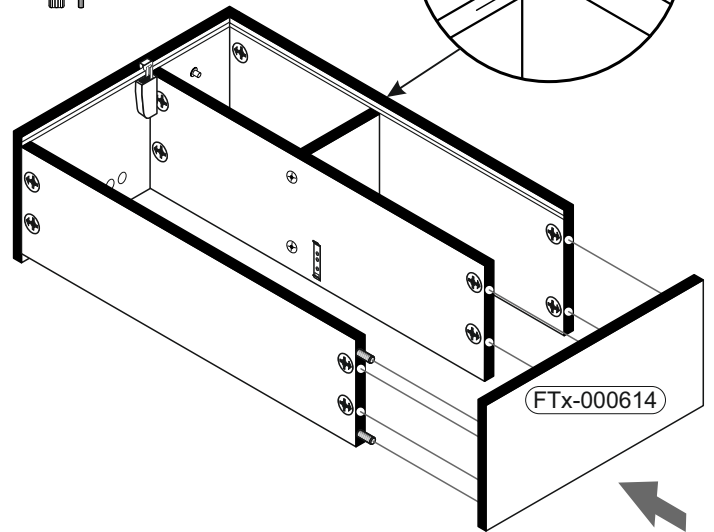
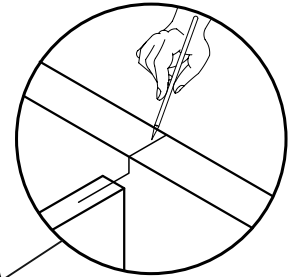

| | | | | | | |
|----|--------|------|---------|----|--------|--|
| 12 | B01-30 | | B05-185 | | B01-90 | |
| | 16x | 3x16 | 4x | 4x | 3,5x20 | |

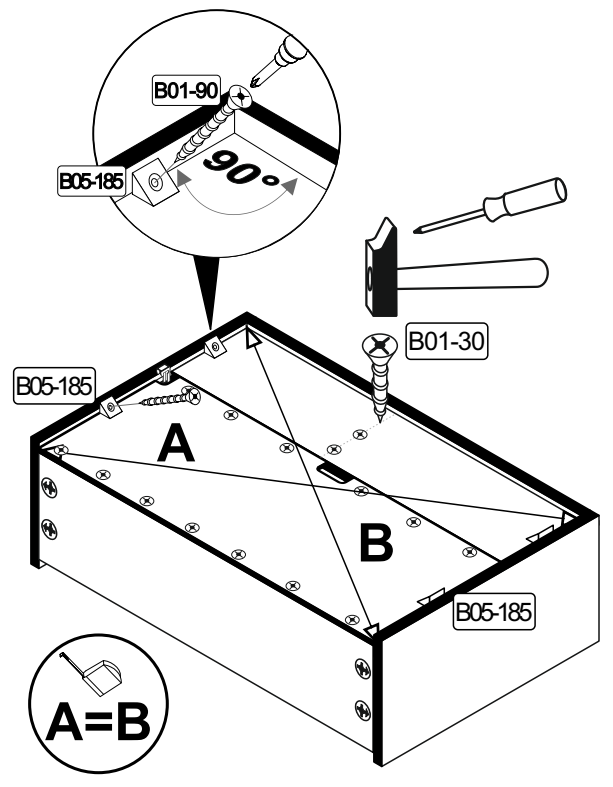
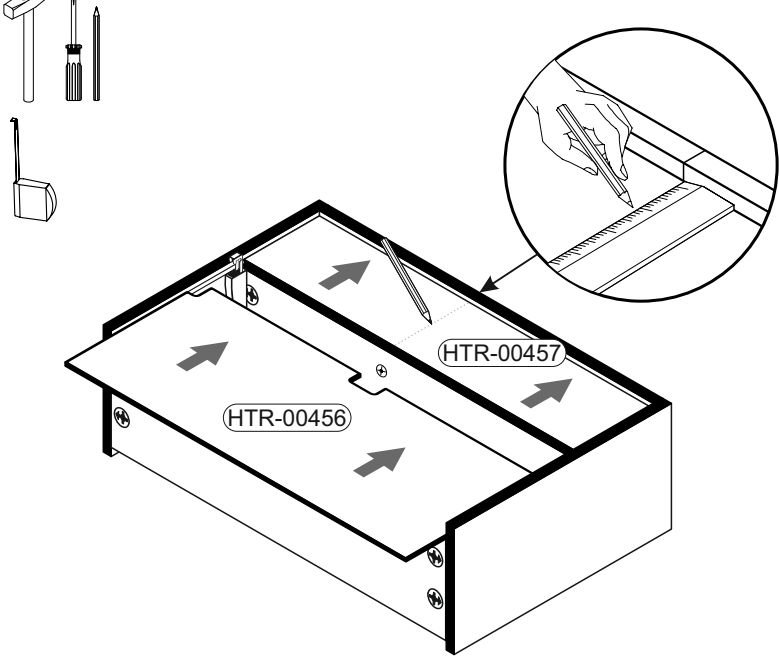

| | | |
|----|--------|------|
| 13 | B01-65 | |
| | 6x | 3x13 |

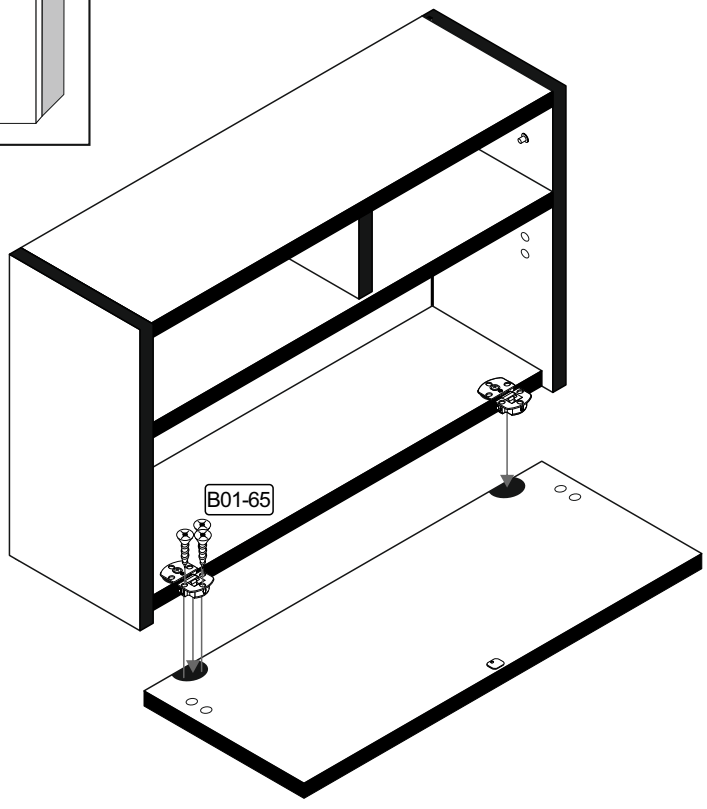
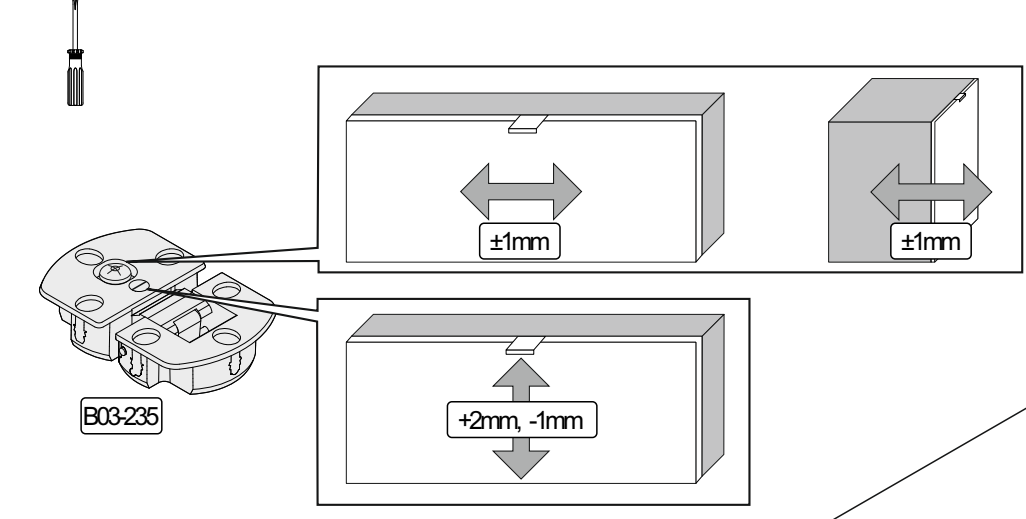

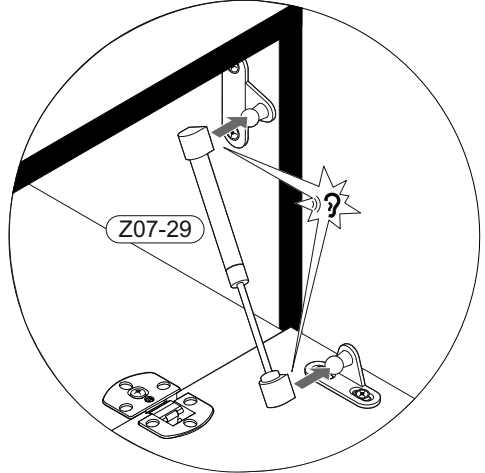
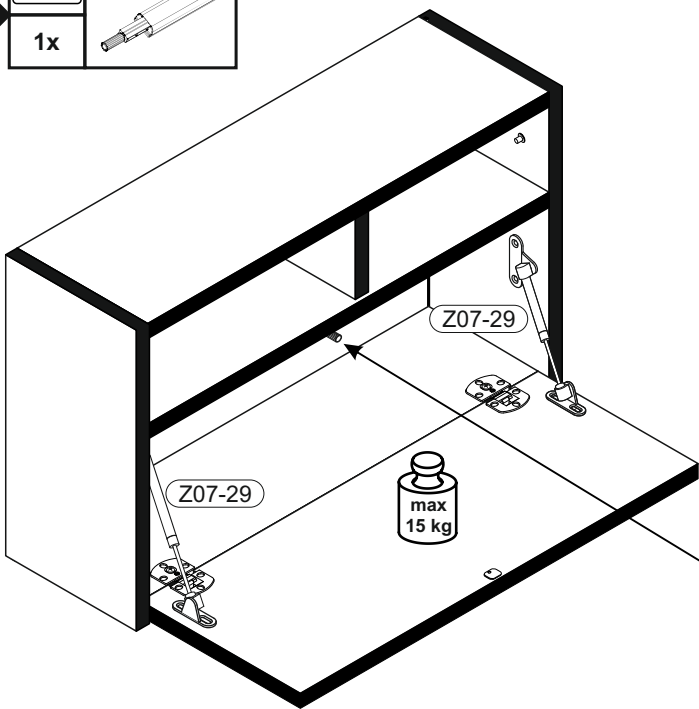
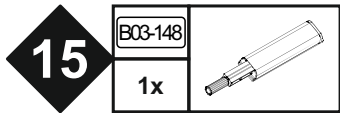
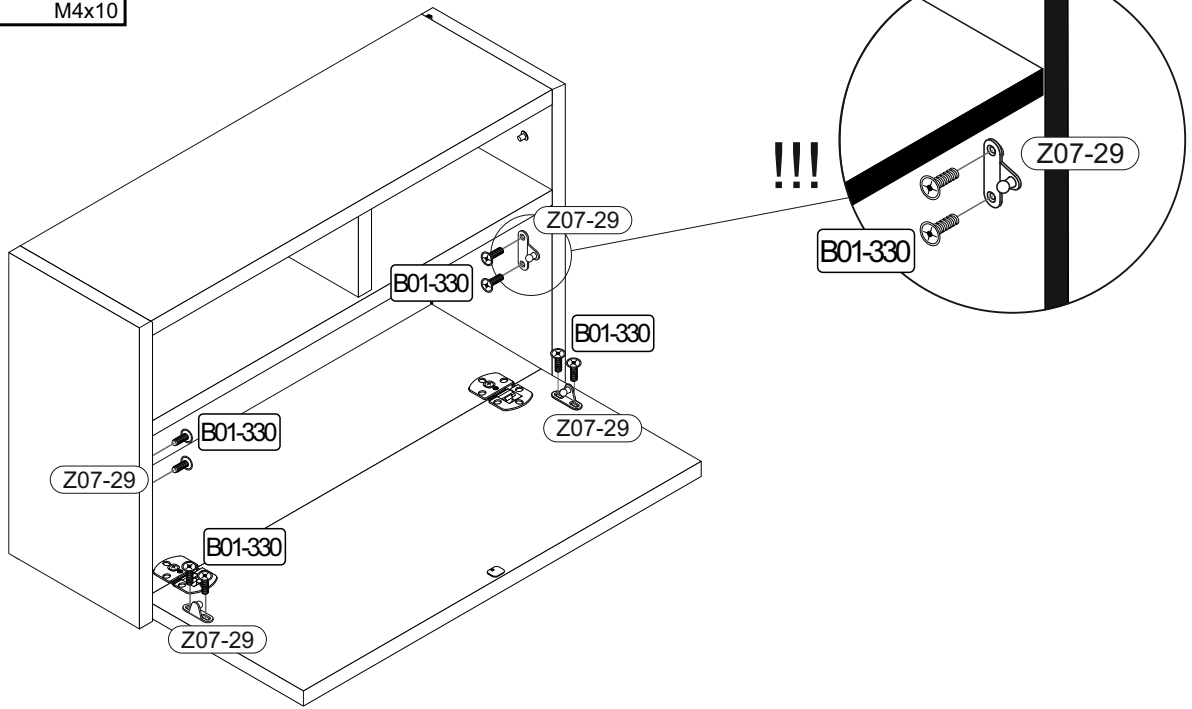
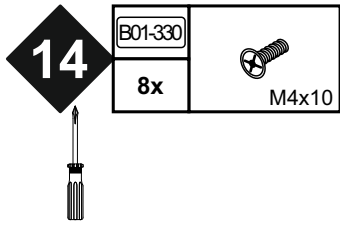

Zur Verstärkung oder Minderung des Hubes das vordere Stück des Beschlages hinein oder heraus drehen.

| | | | | | | |
|----|--------|--------|--------|----|---------|------|
| 16 | B08-40 | | B08-70 | | B03-157 | Push |
| | 2x | 5,8x65 | 2x | Ø8 | 1x | |
| | B08-80 | | | | | |
| | 1x | | | | | |



▶ SCAN ME

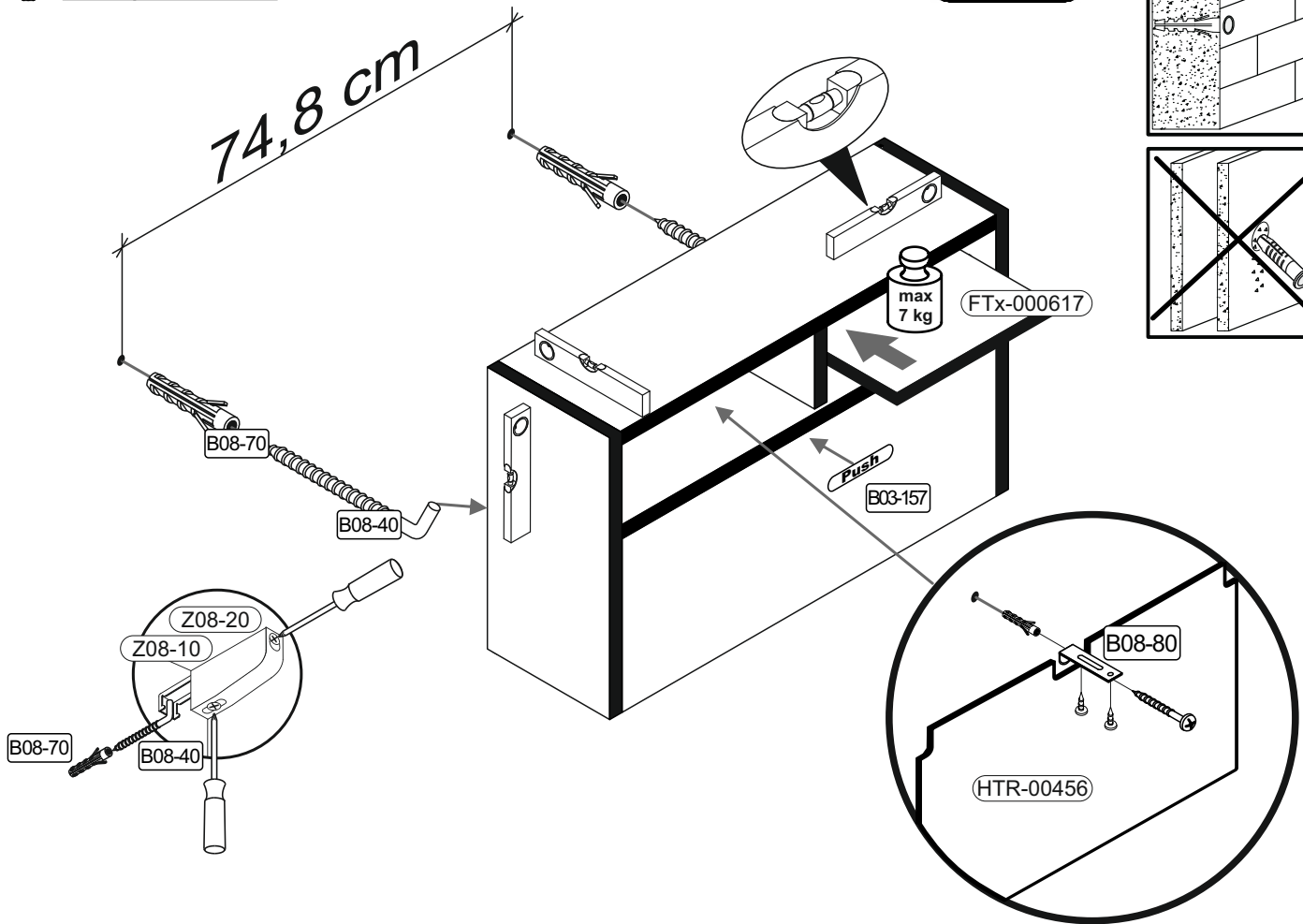
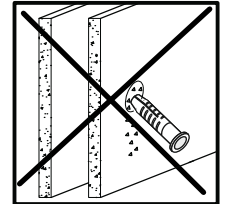
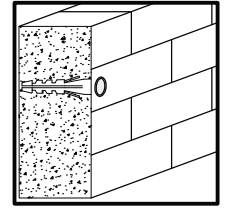

| Achtung • Attention • Attenzione • Opgelet • Uwaga • Pozor • Figyelem • Atenție • Dikkat • Внимание | |
|--|---|
| (D) | Wandbefestigung dient als Kippschutz - unbedingt anbringen! Bei einigen Wandtypen kann ein Spezialdübel erforderlich sein! |
| (GB) | The wall fastening serves to prevent tipping - be absolutely sure to mount it! For certain wall types, a special wall plug may be necessary! |
| (FR) | La fixation murale sert de protection contre le basculement – à installer impérativement ! Pour certains types de murs il faut des chevilles spéciales ! |
| (TR) | Duvardaki sabitleme, devrilmeye karşı bir emniyet tedbiridir ve mutlaka monte edilmelidir! Bazı duvar tiplerinde bunun için özel bir dübel gerekli olabilir! |
| (IT) | Il fissaggio alla parete serve da protezione anti-ribaltamento – attaccarla assolutamente! Per alcune strutture di parete può essere necessario un tassello speciale! |
| (NL) | Bevestiging aan de muur dient als kantelbescherming – zeker en vast bevestigen! Bij enkele muurtypes is een speciale plug misschien vereist! |
| (RU) | Обязательно установите крепление на стене во избежание опрокидывания! Для некоторых типов стен может потребоваться специальный дюбель! |
| (CZ) | Montáž na stěnu slouží jako ochrana proti převrnutí – bezpodmínečně umístěte! U některých typů stěn může být zapotřebí speciální hmoždinka! |
| (HU) | A terméket a falhoz kel rögzíténi, különbén az felborulhat! Egyes faltípusoknál speciális tiplít kell használni! |
| (RO) | Sistemul de fixare la perete servește ca protecție la răsturnare - de montat obligatoriu! Pentru unele tipuri de perți este posibil să fie necesar un diblu special! |
| (PL) | Mocowanie do ściany jest jednocześnie zabezpieczeniem przed przewróceniem – koniecznie zamontować! Do niektórych rodzajów ścian koniecznie zastosować specjalne kołki mocujące. |
| (SK) | Upevnenie na stenu slúži ako ochrana proti prevráteniu – bezpodmienečne použiťe! Pre niektoré druhy stien môže byť potrebná špeciálna hmoždinka! |