

**Tchibo**

# Multifunctional LED Light

en Instructions for use



[www.tchibo.de/instructions](http://www.tchibo.de/instructions)

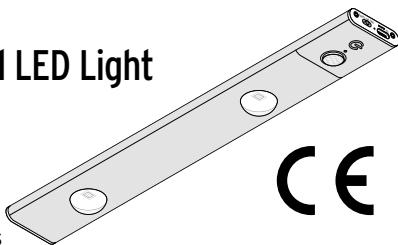

CE



## Safety warnings

Read the safety warnings carefully and only use the product as described in these instructions to avoid accidental injury or damage. Keep these instructions for future reference. If you give this product to another person, remember to also include these instructions.

- The multifunctional LED light is intended for use in dry indoor rooms as an auxiliary light and orientation aid when it is dark. It is not suitable for lighting whole rooms.

It is only intended for use in private homes and is not suitable for commercial purposes.

### **DANGER to children**

- Children are not aware of the risks involved in handling electrical appliances incorrectly. Therefore, keep the product out of the reach of children.
- Keep the packaging materials and small parts out of the reach of children. They pose several risks, including the risk of suffocation/choking!

### **Danger to life/risk of injury due to magnetism for persons with pacemakers/endoprostheses**

- Magnets can potentially impair the function of pacemakers and affect the correct position of endoprostheses in the body. It is therefore important that you keep the magnets away from your body. Before using this product, consult your doctor.

### **Danger due to electricity when charging the battery**

- Do not charge the product outdoors or in damp rooms.
- Use only suitable mains adapters for charging the product. Do not use a faulty mains adapter or attempt to repair a faulty mains adapter.
- Only connect the product to a properly installed power socket with a mains voltage that complies with the technical specifications of the mains adapter used.

- The power socket must be easily accessible so that you can disconnect the mains adapter quickly whenever necessary. Route the charging cable in such a way that it cannot be tripped over.
- Remove the mains adapter from the power socket if malfunctions occur during charging, during thunderstorms and before cleaning the product.

### **Danger of explosion/fire/burns**

- The rechargeable battery is firmly built into the product and cannot and must not be replaced or removed. There is a risk of explosion if the battery is replaced incorrectly. It should be replaced only with an identical rechargeable battery or one of equivalent type. If the rechargeable battery is defective, contact a specialist workshop.
- **Warning!** Lithium rechargeable batteries can explode ...
  - ... if they are exposed to extreme heat, such as sun, fire, etc., or extremely low air pressure during use, storage or transport. Use the product only in moderate climatic conditions.
  - ... if they are taken apart, thrown into fire or short-circuited. Do not place any naked flames such as burning candles near the product. The product must be kept away from candles and other naked flames at all times to prevent the spread of fire.
- Do not modify and/or deform/heat/dismantle rechargeable batteries and do not immerse them in water.

### **WARNING - danger due to improper use**

- The LEDs are very bright. Do not look directly into the light, especially from the front, to avoid eye damage.
- Do not make any modifications to the product. Have repairs to the product carried out only by a specialist workshop. Improper repairs can result in considerable risks to the user.
- Do not use the product if it shows any visible signs of damage or has fallen down.

### **Material damage**

- Keep the magnets away from cards with magnetic strips, such as credit cards, debit cards, etc. These may become damaged. You should also keep the magnets away from CRT screens, magnetic storage media, watches and all devices that are affected by magnetism or could suffer functional impairment.
- Do not use the product outdoors or in damp rooms.
- Never immerse the product in water or other liquids. Protect the appliance from knocks, falls, dust, moisture, direct sunlight and extreme temperatures.
- The built-in LEDs cannot be replaced.
- Do not use caustic or abrasive agents or hard brushes, etc. for cleaning.

- Do not stick the product to sensitive surfaces that would be prone to damage when you later remove the light.
- Do not stick anything to, cover or paint the motion sensor.

---

## Disposal

The product, its packaging and the built-in rechargeable battery have been manufactured from valuable materials that can be recycled. Recycling reduces the amount of refuse and preserves the environment.

Dispose of the **packaging** at a recycling point which sorts materials by type. Make use of the local facilities provided for collecting paper, cardboard and lightweight packaging.



**Appliances, single-use batteries and rechargeable batteries** marked with this symbol must not be disposed of along with household waste!

You are legally obliged to dispose of old appliances separately from household waste. Electronic appliances contain hazardous substances and, if stored or disposed of improperly, may cause harm to health and the environment. Information about collection points where old appliances can be disposed of free of charge is available from your local authorities. Flat single-use and rechargeable batteries must be handed in at a local authority collection point or returned to a battery retailer. Tape off the contacts of lithium single-use/rechargeable batteries prior to disposal.

**Warning!** This appliance contains a rechargeable battery that, for safety reasons, is firmly built into the appliance and cannot be removed without destroying the casing. Improper disassembly leads to safety hazards. For this reason, take the appliance intact to a collection point where the appliance and battery will be disposed of properly.

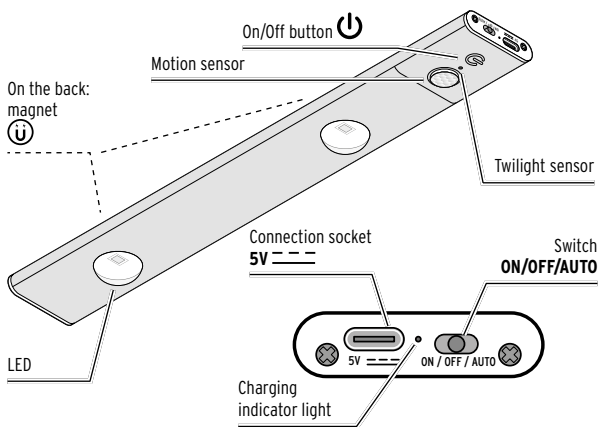

## Charging the battery

The rechargeable battery comes in a half-charged state. This is to prevent it from becoming damaged. Charge the battery fully by connecting a USB mains adapter (not included) to the power supply before using the product for the first time.

**i** You cannot use the light while the battery is charging. As soon as the charging cable is plugged into the connection socket, the light switches off automatically.

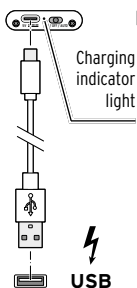

▷ Connect the supplied USB charging cable to the **5V** connection socket of the light and to a suitable USB mains adapter (see "Technical specifications"). Insert the mains adapter into a power socket. The charging indicator light lights up red while the battery is charging.

The usual charging time for a flat battery is approx. 5 hours. Once the charging indicator light turns off, the battery is fully charged.

The appliance is ready for use.

## Information on rechargeable batteries

- You **cannot** use the product while the battery is charging.
- To preserve the rechargeable battery's full capacity for as long as possible, you should fully recharge the battery every 2 to 3 months, even if you do not use the product.
- Charge the battery in an environment between +10 and +40 °C.
- The battery will best hold its charge at room temperature. The lower the ambient temperature, the shorter the operating time.

## Affixing the light

You can attach the light directly to a metallic surface thanks to the integrated magnets - or you can use the supplied self-adhesive metal plates for non-metallic surfaces.

### Using adhesive pads with metal plates

**i** Keep in mind that the adhesive pads may be difficult to remove later on. The removal process may cause paint, wallpaper, etc. to come away from the wall and the pads may leave stains on the surfaces they were stuck to. Where wood or other solid surfaces are concerned, any adhesive residue left can be removed with thinners (benzine or similar). Also observe the manufacturer's instructions when using thinners, and always test them beforehand on an inconspicuous area of the surface in question.

- The adhesive pads will adhere to all smooth and flat surfaces, e.g. mirrored or glass surfaces, tiles, smooth furniture surfaces etc. Do not attach the adhesive pads over joints and other uneven surfaces. The adhesive pads will not adhere to textured surfaces. The surface must be free from dust, grease, silicone and limescale. The adhesive pads are intended for permanent attachment. Avoid attaching them to delicate surfaces if you want to remove them again later. You will get the best hold at temperatures between 23 °C and 40 °C.

1. Clean and degrease the surface with pure alcohol (isopropyl) or methylated spirit. Bathroom or all-purpose cleaners are not suitable. Gently pre-dry the cleaned area and then leave it to dry completely.

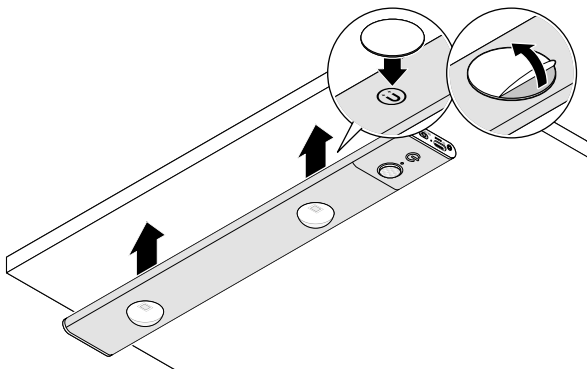

2. The magnets in the light are located exactly opposite the two LEDs (⓪ symbol). Attach the metal plates there.
3. Remove the protective film from the metal plates and place the lamp in the desired position. Press it there firmly for approx. 10 seconds. After approx. 30 minutes, press it again for approx. 10 seconds.

## Use

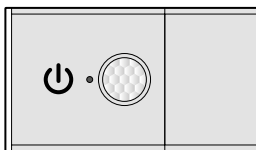
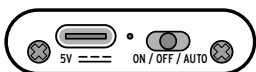

**ON** Slide the switch to **ON** to switch the light on permanently.

Tap  ...

... **briefly** to switch off the light for a short time or back on.

... **longer** to dim the light smoothly from 100% to 10% and - while tapping longer again - back to 100%.

**OFF** Slide the switch to **OFF** to switch the light off permanently.

**AUTO** Slide the switch to **AUTO** to use the motion sensor.

If someone enters the motion sensor's range at dusk or in the dark, the light will switch on and then automatically switch off again after approx. 30 seconds.

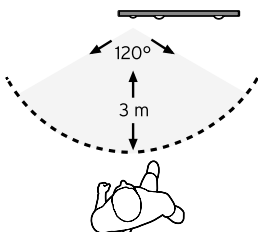

## Technical specifications

Model:	727 292
Rechargeable battery:	lithium-ion 3.7 V DC 1500 mAh, Watt-hour rating: 5.55 Wh (tested as per UN 38.3) (non-replaceable)
Charging time:	approx. 5 hours
Operating time:	approx. 10 hours (at 100% brightness)
Automatic switch-off after:	approx. 30 seconds
Coverage angle of the sensor:	approx. 120°
Range of the sensor:	3 m
Made exclusively for:	Tchibo GmbH, Überseering 18, 22297 Hamburg, Germany

**Product number: 727 292**