

Popcorn maker

en Instructions for use

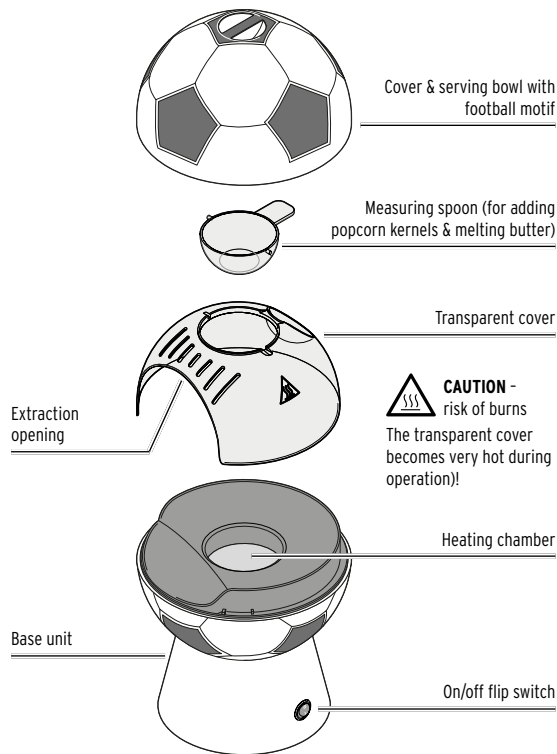

At a glance (contents)



Technical specifications

Model:	PM 020
Product number:	730 726
Mains voltage:	220 - 240 V ~ 50 Hz
Protection class:	I
Power:	1200 W
Short-term operation:	max. 4 minutes
Cooling time:	min. 15-20 minutes
Ambient temperature:	+10 to +40 °C
Manufactured by:	Jaxmotech GmbH, Ostring 60 66740 Saarlouis, Germany info@jaxmotech.de

As part of our product improvement process, we reserve the right to make technical and visual modifications to the product.

Product number: 730 726

Dear Customer

You can use your new popcorn maker to prepare fresh, delicious popcorn for your football TV session or home cinema evening in just a few minutes.

It is very easy to use, and you can serve the popcorn straight away in the football-themed lid of the popcorn maker.

Bon appétit!

About these instructions

This product is equipped with safety features. Nevertheless, read the safety warnings carefully and only use the product as described in these instructions to avoid accidental injury or damage.

Keep these instructions for future reference.

If you give this product to another person, remember to also include these instructions.

Symbols used in these instructions:



This symbol warns you about the danger of injury.



This symbol warns you about the risk of injury caused by electricity.



This symbol warns you about the risk of burns caused by hot surfaces.

Signal words used in these instructions:

WARNING warns about the potential risk of serious or fatal injury.

CAUTION warns about the potential risk of minor injury.

NOTICE warns about the potential risk of material damage.



This indicates additional information.

For your safety

Intended use

The popcorn maker is intended for making popcorn. Only use kernels intended for making popcorn. **Apart from the popcorn kernels, do not put any other ingredients - in particular liquids, fat, sugar, salt etc. - in the heating chamber of the popcorn maker.**

The appliance must not be used to prepare any other foods.

The appliance is intended for private use and for the preparation of standard household quantities. It is not suitable for commercial use or in situations similar to home use, for example in the staff kitchens of shops, offices or other areas of commerce, in agricultural buildings, by customers in hotels, motels, bed and breakfast establishments or any other places offering accommodation.

Danger to children and to people with limited ability to operate appliances

• This appliance may be used by children aged 8 and over and by people with reduced physical, sensory or mental capabilities or a lack of experience and/or knowledge, provided they are supervised or have been trained in the safe use of the appliance and understand the potential dangers.

• Children must not be allowed to clean the appliance unless they are over 8 years of age and supervised while doing so. This machine is maintenance-free.

- The appliance becomes very hot. Supervise children to ensure they do not touch any of the hot parts of the appliance during use and while it is cooling down. The appliance and its mains cable must be kept out of the reach of children under the age of 8 once the appliance is switched on and until it has cooled down completely after use.
- Keep the appliance and its mains cable out of the reach of children under 8 years of age when it is not in use.
- Children must not be allowed to play with the appliance.
- Keep the packaging materials out of the reach of children. They pose several risks, including the risk of suffocation!

Danger due to electricity

- Only connect the product to a properly installed, earthed power socket with a voltage that complies with the technical specifications of the product.
- Never immerse the appliance or its plug in water, as this poses a risk of electric shock. Under no circumstances should you pour any liquids into the appliance. Protect the appliance from drops and splashes of water.
- Do not operate the appliance while your hands are damp.
- The appliance must not be operated outdoors or in rooms with high humidity, such as a garage or cellar. Also do not use the appliance in the immediate vicinity of sinks or washbasins.
- If you need to use an extension cable, it must comply with the "Technical specifications". Seek advice in a specialist shop when buying an extension cable.
- The appliance must not be operated using a timer mechanism or with a separate remote control system.
- Unplug the mains plug from the power socket ...
 - ... if malfunctions occur during use,
 - ... after use,
 - ... during thunderstorms and
 - ... before cleaning the appliance.Always pull on the plug, not on the mains cable.
- The power socket used must be within easy reach so that the mains plug can be removed quickly if necessary. Route the mains cable so that the appliance cannot be accidentally pulled down by it.
- The mains cable must not be kinked or crushed. Keep it away from hot surfaces or sharp edges.
- Do not use the appliance if the appliance itself or the mains cable shows any visible signs of damage or if the appliance has fallen down. Only use the appliance with the original accessories.
- Do not make any modifications to the product or replace the mains cable yourself. Have repairs to the product carried out only by a specialist workshop. If the mains cable is damaged, it must be replaced only by the manufacturer, the manufacturer's customer care service or a similarly qualified person with a suitable mains cable in accordance with the technical specifications in order to avoid hazards.

Danger of fire

- Never leave the appliance unattended while it is in operation.
- Place the appliance on a stable, level and heat-resistant surface or mat.
- Position the appliance for use so that it is free-standing on a table, never against a wall or in a corner, in a cupboard, or against curtains or anything similar. Keep flammable material away and do not cover the appliance.

Danger of burns

- The appliance will get hot during use! Always wear oven gloves or similar when handling the appliance. Ensure that nobody touches the hot surfaces during use or while the appliance is cooling down.
- Do not operate the appliance without the transparent cover in place and always close the top opening with the measuring spoon.
- The popcorn itself is also very hot immediately after it pops. Allow it to cool for a moment before touching, transferring or eating it.
- Do not move the appliance while it is in use. Unplug the appliance and let it cool down completely before transporting it, storing it away or cleaning it.

Material damage

- Protect the appliance from impacts, falls, dust, moisture, direct sunlight and extreme temperatures.
- Place the appliance on a stable, level and heat-resistant surface or mat that is easy to clean. Maintain a sufficient distance from sources of heat, such as ovens or hobs.
- The appliance is equipped with overheating protection. However, switch the appliance off after each cooking cycle and allow it to cool down for at least 15-20 minutes before using it again.
- Do not use more than a maximum of 60 g of popcorn kernels (= 1 level measuring spoon) per cooking cycle so as not to overflow the appliance.
- Under no circumstances should you put salt, sugar, butter or any other additional ingredients into the heating chamber. Always season or refine the popcorn after preparation in a separate bowl.
- Do not use caustic or abrasive agents, hard brushes or pan-cleaning sponges etc. for cleaning.

Disposal

This product and its packaging have been manufactured from valuable materials that can be recycled. Recycling reduces the amount of refuse and preserves the environment.

Dispose of the **packaging** at a recycling point which sorts materials by type. Make use of the local facilities provided for collecting paper, cardboard and lightweight packaging.



Appliances marked with this symbol must not be disposed of along with normal household waste!
You are legally obliged to dispose of old appliances separately from household waste. Electronic appliances contain hazardous substances and, if stored or disposed of improperly, may cause harm to health and the environment. Information about collection points where old appliances can be disposed of free of charge is available from your local authorities.

Making popcorn

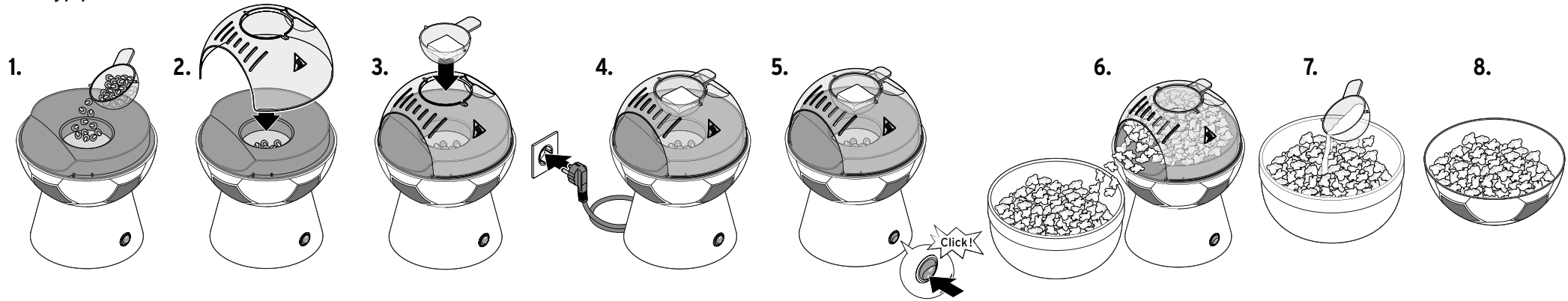

Prior to first use

WARNING - risk of fire

- Never leave the appliance unattended while it is in operation.
- Position the appliance so that it is free-standing for use, never against a wall, in a corner, in a cupboard or near curtains etc.

NOTICE - material damage

- Only clean the accessories by hand. They are not suitable for cleaning in the dishwasher.

1. Remove all packaging material and dispose of it immediately so that children cannot get hold of it.
2. Wipe the base unit and heating chamber clean with a slightly damp, soft cloth. Then dry them off thoroughly with a dry cloth.
3. Wash all accessories (lid, transparent cover, measuring cup) by hand in warm water with a little washing-up liquid. Carefully dry all parts afterwards.

Before using the popcorn maker for the first time, heat it up once **without any kernels** as follows:

There may be a slight odour when using the appliance for the first time. This is harmless. Make sure there is sufficient ventilation.

1. Place the base unit on a flat, heat-resistant and non-sensitive surface near a suitable earthed socket.
2. Place the transparent cover on the base unit (not the closed football-motif lid).
3. Insert the mains plug into an easily accessible socket and flip the On/Off switch to **I** to turn the appliance on.
4. Switch the appliance off again after approx. 2 minutes by flipping the on/off switch to **O**.
5. Disconnect the mains plug from the power socket and leave the appliance to cool down for 15-20 minutes.
6. Once the heating chamber has cooled down, wipe it thoroughly with a kitchen cloth.

Use

WARNING - risk of fire

- Never leave the appliance unattended while it is in operation.

CAUTION - risk of burns

- Do not operate the appliance without the transparent cover in place and always close the top opening with the measuring spoon.
- The heating chamber and transparent cover will become very hot during operation and hot steam will be generated. Ensure that nobody touches the hot parts of the appliance during use. Always wear oven gloves or similar protection when handling the appliance.
- The popcorn itself is also very hot immediately after it pops. Allow it to cool for a moment in the collection vessel before touching, transferring or eating it.
- Do not add any new kernels during preparation and do not remove the transparent cover, as the hot popcorn may pop out uncontrollably.
- Always wear oven gloves or similar protection when handling the appliance.

NOTICE - material damage

- Do not place any spices such as sugar, salt, etc. in the heating chamber, as these will burn and cause damage to the appliance.

1. Place the base unit on a flat, heat-resistant and non-sensitive surface near a suitable earthed socket.
2. Add the popcorn kernels (max. 60 g = 1 level measuring spoon) to the heating chamber using the measuring spoon. **Do not add any other ingredients such as butter, oil, sugar, salt etc.**
3. Place the transparent cover on the base unit.
4. Seal the top opening with the measuring spoon. Ensure that the measuring spoon is positioned in the recesses provided.

You can either use the measuring spoon empty as a lid or melt butter in it while making popcorn to refine the finished popcorn later.

5. Place a suitable heat-resistant bowl (not included) that is large enough to catch the finished popcorn next to the appliance. Due to its small size, the football-motif bowl is not optimal for this purpose, because too much popcorn would fly past it.

6. Insert the mains plug into an easily accessible socket and flip the On/Off switch to **I** to turn the appliance on.

After a short time, the first kernels will begin to pop and slowly fill the appliance, at increasing speed, until they finally fall out of the opening into the collection vessel you have provided. Depending on the amount used, the preparation cycle takes approx. 2-4 minutes.

7. When there are only a few kernels still popping - but after a maximum of 4 minutes - flip the On/Off switch to **O** to switch the appliance off. Remove the mains plug from the socket if you do not wish to make any more popcorn.

8. Allow the appliance to cool for a moment before removing the transparent cover and pouring the popcorn remaining in the appliance into the vessel you have provided. Always use oven gloves or similar protection.

9. Now you can refine the finished popcorn in the collection bowl with the melted butter, if desired, and add sugar, salt or similar to taste. Stir the popcorn gently.

10. Finally, transfer the popcorn to the football-motif serving bowl. Enjoy your popcorn!

11. Wait at least 15-20 minutes before preparing another portion as described.

Sometimes, some of the kernels do not pop. Remove these from the heating chamber before starting the next preparation cycle.

Overheating protection

This appliance is equipped with an overheating protection function. If the appliance is not switched off with the On/Off switch after max. 4 minutes and gets too hot, it will turn off automatically and turn on again automatically once it has cooled down sufficiently.

- ▷ To prevent the appliance from heating up unintentionally, always switch the appliance off by flipping the On/Off switch to **O**.

Problems / solutions

Not working.

Is the plug connected to a power socket?

Is the overheating protection function activated (the appliance is not heating even though the On/Off switch is set to **I**)?

A large number of kernels do not pop.

Was the appliance switched off too early?

Depending on the amount used, the preparation cycle takes approx. 2-4 minutes.

Cleaning

WARNING - risk of fatal electric shock

- Remove the mains plug from the power socket before cleaning the appliance.
- Never immerse the appliance or its plug in water, as this poses a risk of electric shock. Protect the appliance from drops and splashes of water.

CAUTION - risk of burns

- Let the appliance cool down sufficiently before cleaning it and storing it away.

NOTICE - material damage

- Do not use caustic or abrasive agents, hard brushes or pan-cleaning sponges etc. for cleaning.
- Only clean the accessories by hand. They are not suitable for cleaning in the dishwasher.

1. Ensure that the appliance is disconnected from the power supply and has cooled down sufficiently.
2. Remove any unpopped kernels from the heating chamber.
3. Wash all accessories (lid, transparent cover, measuring cup) by hand in warm water with a little washing-up liquid. Carefully dry all parts afterwards.
4. Wipe the base unit and heating chamber clean with a slightly damp, soft cloth. Then dry them off thoroughly with a dry cloth.
5. Let all the parts dry thoroughly before reassembling and storing the appliance.