

Power bank

en Instructions for use

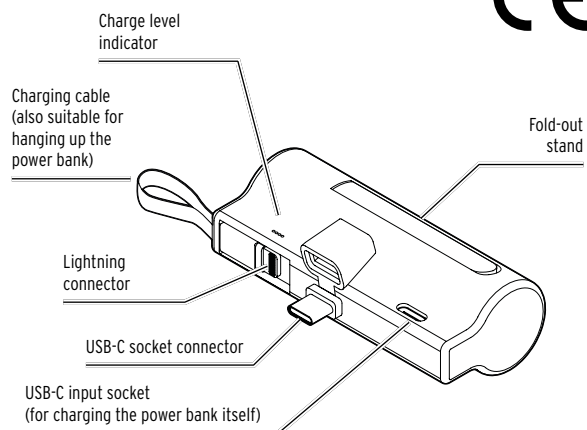

Product number: 734 959



Danger due to electricity

- Only use a suitable USB mains adapter that corresponds to the "Technical specifications" to charge the power bank.
- Do not use or attempt to repair faulty USB mains adapters.
- Only connect the USB mains adapter to a properly installed power socket whose voltage complies with the technical specifications of the device.
- Unplug the mains adapter from the power socket once the power bank is fully charged, during thunderstorms, before cleaning the product and if malfunctions occur while charging. Always pull on the mains adapter, not on the USB charging cable.
- The socket must be easily accessible so that you can disconnect the mains adapter quickly whenever necessary. Lay the USB charging cable in such a way that the device cannot be accidentally pulled off the table.

- Do not place any containers (e.g. vases) filled with liquid near the power bank.
- Observe the instructions for use of the mobile devices you wish to charge. If necessary, switch off the mobile devices you wish to charge beforehand.
- Do not take the product apart. Do not make any modifications to the product. Improper repairs can result in considerable risks to the user. Only have repairs to the product carried out by a specialist workshop.
- The product contains a lithium-ion rechargeable battery. This battery must not be removed or replaced, taken apart, thrown into fire or short-circuited. There is a risk of explosion if the battery is replaced incorrectly. If the rechargeable battery is faulty, contact a specialist workshop.
- Do not modify and/or deform/heat/dismantle rechargeable batteries. Do not allow damaged rechargeable batteries to come into contact with water.
- Do not use the device or connect it to the mains for charging if the device itself is visibly damaged, or if the device has been dropped.

Material damage

- Only use the power bank at an ambient temperature between 0 °C and +40 °C (while charging the power bank itself), 0 °C and +40 °C (when discharging or charging an external device) and at an air humidity between 40% and 70%.
- Do not physically overload the charging cable on the Lightning connector. Do not hang key rings or other objects on it.
- Do not use any caustic chemicals, or aggressive or abrasive detergents for cleaning.

Important information regarding the power bank

If you would like to take the power bank on a plane, you should enquire with the airline beforehand about whether and under which circumstances you are permitted to take a power bank on board.

Use

- To ensure that the power bank keeps working properly, charge it up regularly.
- If the internal capacity of the power bank is too low or if it encounters electrical problems, the power bank will switch itself off to protect the connected device from any damage.
- Be sure to read the instruction manual of your mobile device.

Charging the power bank

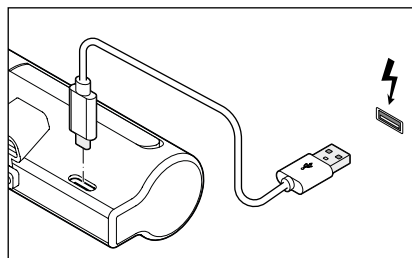

1. Connect the power bank as shown using a USB-C/USB-A connection cable (not included) to the USB-C input socket of the power bank and a USB mains adapter (not included).
2. Insert the mains adapter into a power socket.

The four indicator lights display the charge state of the power bank (25% - 50% - 75% - 100%):
 Charge state indicator light ...
 ... **lights up white** - capacity reached
 ... **flashes white** - charging in progress.
 ... **is not lit up** - charging has not yet begun.

Once all four indicator lights are lit up white, the power bank is fully charged.

The power bank is ready to charge mobile devices.

You can leave it connected to the power supply or pull out the mains adapter and charging cable.

Charging rechargeable mobile devices (smartphones etc) with the power bank

- Be sure to read the instruction manual of your mobile device.
- To charge your mobile device, you can use either the USB-C connector plug or the Lightning connector on the power bank. The choice depends on the connection of the mobile device you want to charge. You can only use one of the connector plugs at a time.

1. Connect your mobile device either ...

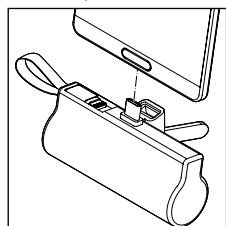

... to the USB-C connector plug or ...

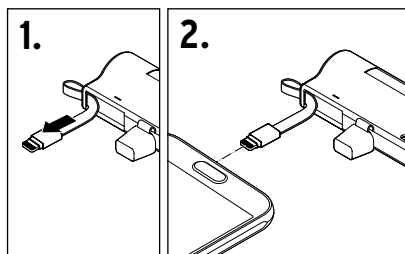

... to the Lightning connector on the power bank.

The power bank will begin to charge automatically.

The indicator lights for the charge state ...

... light up white when a device is charging.

... flash white when the power bank no longer has sufficient charging capacity to charge the connected mobile device. The power bank itself needs charging before the next use.

The charging time depends on the rechargeable battery capacity of the device you wish to charge.

- ▷ When the device is fully charged or you wish to end the charging process prematurely, simply disconnect the power bank from the terminal device.

Setting up the power bank

You can use the power bank as a stand for your smartphone, e.g. to watch films, whilst your smartphone is simultaneously charging.

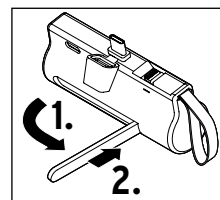

1. Fold out the stand on the back as shown until it clicks into place audibly and visibly.

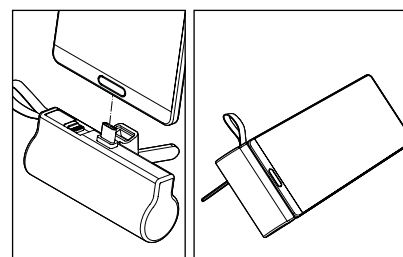

2. Connect the smartphone to the USB-C connector plug. Caution - ensure that the surface is stable and flat. Position the power bank and smartphone in such a way that neither of them can fall a long way onto a hard surface if the devices tip over.

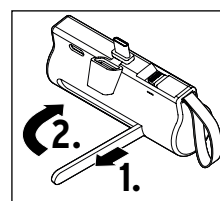

3. Simply fold the stand back in after use.

Problems / solutions

The connected mobile device is not charging

- Is the power bank sufficiently charged? Connect it to the power supply if required.
- If you are using the power bank near strong magnetic fields (e.g. television devices / speakers), the charging process may malfunction. Change the location, disconnect the power bank from the mobile device and then reconnect them.

Resetting

Electromagnetic interference around the product could lead to malfunctions. If the power bank is not working properly, disconnect the mobile device from the power bank and reconnect them.

Technical specifications

Model:	PB 19
Product number:	734 959
Rechargeable battery:	3.7 V Lithium-ion, 2500 mAh Watt-hour rating: 9.25 Whh (tested as per UN 38.3) (non-replaceable)
Input:	DC 5 V / 2 A
Output:	USB-C: DC 5 V / 2 A Lightning: DC 5 V / 2 A

Charging time (power bank): approx. 2.5 h

Ambient temperature

Charging: 0 to +40 °C
Discharging: 0 to +40 °C

Manufactured by: Jaxmotech GmbH, Ostring 60,
66740 Saarlouis, Germany,
info@jaxmotech.de

Disposal

The product, its packaging and the built-in rechargeable battery have been manufactured from valuable materials that can be recycled. Recycling reduces the amount of refuse and helps to preserve the environment. Dispose of the **packaging** at a recycling point that sorts materials by type. Make use of the local facilities provided for collecting paper, cardboard and lightweight packaging.

Devices, single-use batteries and rechargeable batteries marked with this symbol must not be disposed of along with household waste!

You are legally obliged to dispose of old devices separately from household waste. Electronic devices contain hazardous substances and, and, if stored or disposed of improperly, may cause harm to health and the environment. Information about collection points where old devices can be disposed of free of charge is available from your local authorities.

Flat single-use and rechargeable batteries must be handed in at a local authority collection point or returned to a battery retailer. Tape off the contacts of lithium single-use/rechargeable batteries prior to disposal.

Warning! This device contains a rechargeable battery that, for safety reasons, is firmly built into the device. It cannot be removed without destroying the casing. Improper disassembly leads to safety hazards. For this reason, take the device intact to a collection point where the device and battery will be disposed of properly.

Information about the built-in rechargeable battery:

Manufacturer: Guangdong Nuoda Smart Energy Technology Company Limited
Address: No.2, Xinglin Road, China & South Korea Industrial Park, Qibu Zone, Zhongkai High-Tech District, Huizhou City Guangdong Province China
Email: szhlhai@163.com **Manufacturing date:** 2025-11
Made in: China