

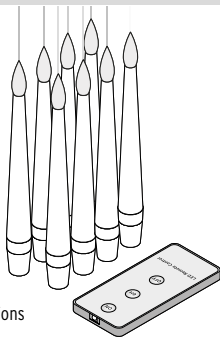

Made exclusively for:
 Tchibo GmbH,
 Übersering 18,
 22297 Hamburg,
 Germany



Safety warnings

Read the safety warnings carefully and only use the product as described in these instructions in order to avoid accidental injury or damage. Keep these instructions for future reference. If you give this product to another person, remember to also include these instructions.

The product is only suitable for decoration in private homes and not for lighting whole rooms. The product is designed for indoor and outdoor use. It is designed for private use and is not suitable for commercial purposes.

- This is not a children's toy! Use only under adult supervision. Keep the product and packaging materials out of the reach of infants. Small swallowable parts pose several risks, including the risk of choking! Long cords pose a risk of strangulation!
- Do not switch the product on while it is still in the packaging.
- The LEDs are firmly built in and cannot and must not be replaced.
- Handle the product with care. Impacts, shocks and falls - even from a low height - may damage the product. For this reason, check regularly that the adhesive pads are firmly attached to the respective surface.
- Do not use any caustic, aggressive or abrasive products for cleaning.

The remote control contains a lithium battery (coin battery).

There is a risk of leakage, gas emissions, explosion and fire:

- Swallowing batteries can be fatal. The remote control is fitted with a lithium coin battery. Swallowing the coin battery or one of the other batteries can cause severe internal chemical burns and even death within 2 hours. For this reason, keep both new and old batteries, the product and its remote control unit out of the reach of children. If one of the battery compartments does not close properly, discontinue use of the product and keep it out of the reach of children. If you think that a battery has been swallowed or has got into the body in any other way, seek medical advice immediately.
- Batteries may only be inserted or replaced by adults.
- Warning! Lithium batteries can explode if inserted incorrectly. It is therefore essential to ensure that the polarity (+/-) is correct when inserting the lithium coin battery and the other batteries. Use only batteries of the same or an equivalent type (see "Technical specifications").
- If necessary, clean the battery and device contacts before inserting the batteries. Risk of overheating!
- Single-use batteries must not be charged, taken apart or crushed, thrown into fire or short-circuited. Do not modify and/or deform/heat/dismantle single-use batteries. Do not allow damaged batteries to come into contact with water.
- Batteries must not be overdischarged. Keep unused batteries in the original packaging. Unpacked batteries (either new or partially/fully used) must be stored in an orderly fashion so that their contacts cannot touch each other and must be kept away from metal objects.
- Protect batteries/the product from excessive heat (heaters, direct sunlight). Remove the batteries from the product and its remote control when they are flat or if you do not intend to use the product for a longer period of time. This will help prevent damage caused by leakage.
- If a battery has leaked, avoid contact with skin, eyes and mucous membranes. If necessary, rinse the affected areas with plenty of clear water and consult a doctor immediately.
- The LED candles are suitable for outdoor use and comply with protection type IP44. This means that the product is protected against contact with tools, wires and foreign objects with a diameter larger than 1 mm and splashes of water, such as rain. However, you should protect it from heavy rain, running water and puddles. The product must under no circumstances be immersed in water, as this would destroy it.
- Stop using the LED candles outdoors if the sealing ring on the battery compartment is improperly mounted or is damaged.
- Protect the product from extreme temperatures. Store the LED candles indoors if the temperature falls below -10 °C, otherwise they may become damaged.
- Protect the remote control from knocks, falls, dust, moisture, direct sunlight and extreme temperatures. Always keep it indoors.

- The product is not designed to withstand strong winds, storms, etc.! Take down the LED candles in good time if strong winds or storms are forecast.

Use

Inserting a battery into an LED candle

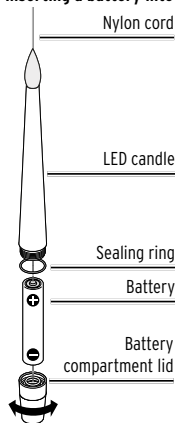

1. Remove the battery compartment lid by turning it anti-clockwise.
2. Insert the battery as illustrated. In doing so, make sure that the polarity is correct (+/-).
3. Screw the battery compartment lid back on by turning it clockwise. Ensure that the sealing ring is correctly positioned. The candle will light up once the battery compartment lid is securely closed.

- ▷ If required, switch the candle off using the remote control.

Hanging up the LED candles

Bear in mind:

- The adhesive pad mounts are designed to be used just once for attachment. For this reason, before attaching the mounts, think about where you want to place the LED candles.
- For the adhesive pads to attach securely, the respective surface must be sufficiently firm, smooth, clean, dry and free of dust and grease. Uneven and highly porous surfaces are not suitable.
- If you do decide to remove the adhesive pad mounts later on, some adhesive residue may remain on the surface or paint, wallpaper, etc. may detach from the surface.
- The nylon cords are securely attached to the LED candles. It is best to test the hanging arrangement before final installation, trimming the cords if necessary.

1. Unwind the nylon cord completely.



2. Once the nylon cord is the desired length, attach it to the mount.



3. Remove the protective film from the adhesive pad.



4. Press the adhesive pad firmly onto the surface to attach the mount and candle to the desired position on the ceiling.

Activating the remote control

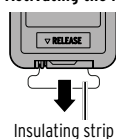

The remote control comes fitted with an insulating strip to protect the battery.

- ▷ To activate the remote control, pull the insulating strip out of the battery compartment.

Using the remote control

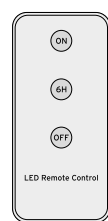

The remote control has a range of approx. 5 m and will detect candles within a radius of approx. 50 cm.

- ▷ Point the remote control in the direction of the candles. Ensure there are no objects blocking the space between the remote control and the candles.

Switching the LED candles on and off continuously

- ▷ Press the **ON** button on the remote control to switch the LED candles on continuously.
- ▷ Press the **OFF** button on the remote control to switch the LED candles off continuously.

Switching the LED candles on in timer mode

- ▷ Press the **6H** button on the remote control once to activate the LED candles in timer mode: The LED candles will flash once and then stay on for **6 hours**. They will then switch off automatically for **18 hours**, then back on again for 6 hours, and so on.

- ▷ Press the **6H** button again to restart the timer cycle: The LED candles will flash once and then stay on again for a full 6 hours before switching off for 18 hours, and so on.
- ▷ Press the **OFF** button on the remote control to deactivate timer mode and switch the LED candles off prematurely.

Replacing the battery in the remote control

If the LED candles no longer respond to the remote control, the battery must be replaced. The battery compartment is located at the bottom on the back of the remote control.

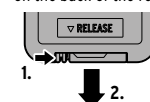

- 1.
- 2.

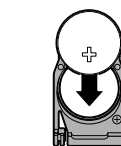

1. Press the small lever in and pull out the battery holder.

2. Replace the flat battery with a new one (see "Technical specifications"). Ensure that the polarity (+/-) is correct when doing so (+ symbol facing upwards).

- Touching the battery with bare hands may cause contamination on the contacts, and this may have an insulating effect. Therefore, use a dry, soft cloth to insert the battery.

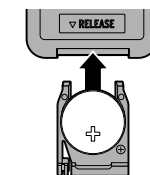

3. Push in the battery holder completely. You must hear and feel it click into place.

Technical specifications

Model:	759 994
Candles	
Single-use battery:	8x LR03 (AAA)/1.5 V (Zn/MnO ₂)
Bulb:	LED
IP code:	IP44
Remote control	
Battery:	1x CR2025/3 V (Li/MnO ₂)
(tested as per UN 38.3)	Watt-hour rating 0.45 Wh
Range:	5 metres
Operating time:	approx. 140 hours (with one set of batteries)
Ambient temperature:	-10 °C to +40 °C

In the course of product improvement, we reserve the right to make technical and visual modifications to the product.

Disposal

The product, its packaging and the batteries provided have been manufactured from valuable materials that can be recycled. Recycling reduces the amount of refuse and preserves the environment. Dispose of the **packaging** at a recycling point that sorts materials by type. Make use of the local facilities provided for collecting paper, cardboard and lightweight packaging.



Devices, single-use batteries and rechargeable batteries

marked with this symbol must not be disposed of along with household waste! You are legally obliged to dispose of old devices separately from household waste. Electronic devices contain hazardous substances and, if stored or disposed of improperly, may cause harm to health and the environment. Information about collection points where old devices can be disposed of free of charge is available from your local authorities. Flat single-use and rechargeable batteries must be handed in at a local authority collection point or returned to a battery retailer. Tape off the contacts of lithium single-use/rechargeable batteries prior to disposal.

Product number: 759 994