

# Electric facial hair remover

## At a glance (contents)

### Also included (not illustrated):

1x battery

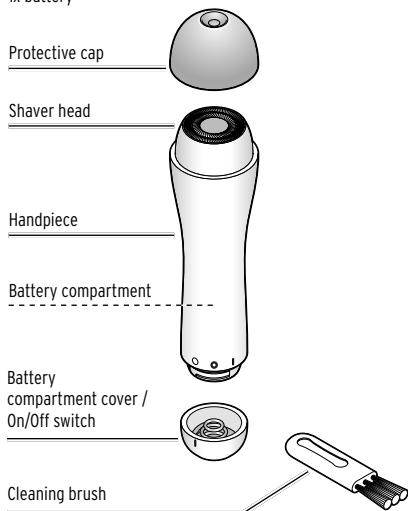

## For your safety

Read the safety warnings carefully and only use the product as described in these instructions to avoid accidental injury or damage. Keep these instructions for future reference. If you give this product to another person, remember to also include these instructions.

### Intended use

The device is intended for shaving fine hair on the face or other parts of the body. It is not suitable for shaving large areas. The device has been designed for private use and is not suitable for commercial purposes.

### Danger to children and to people with limited ability to operate devices

- This device can be used by children aged 8 and over and by people with reduced physical, sensory or mental capabilities or a lack of experience and/or knowledge, provided they are supervised or have been trained in the safe use of the device and understand the potential dangers. Children must not be allowed to play with the device. Cleaning and user maintenance must not be carried out by children without supervision.
- Keep small parts and packaging material out of the reach of children. There is a risk of suffocation and injury!

- Swallowing batteries can be fatal. If a battery is swallowed, it can cause severe internal chemical burns and even death within 2 hours. Therefore, keep both new and old batteries and the product out of the reach of children. If you think a battery has been swallowed or has entered the body in any other way, seek medical advice immediately.

### Risk of injury

- Only apply gentle pressure during use.
- Shaving sensitive skin can lead to skin irritation. Start by testing a small area to see how your skin reacts. If you are shaving regularly for the first time, your skin will need time to get used to it. If you use the device daily, this will take approximately 2-3 weeks.
- The device must not be used if the device itself or its shaver head show any signs of damage. Only use the original accessories.
- The single-use battery provided must not be charged, taken apart, thrown into fire or short-circuited.
- If the battery leaks, avoid contact with skin, eyes and mucous membranes. If necessary, rinse the affected areas with water and consult a doctor immediately.

### Material damage

- When inserting the battery, ensure that the polarity (+/-) is correct.
- If necessary, clean the battery and device contacts before inserting the battery. Risk of overheating!
- When cleaning the device, the battery compartment cover must be securely closed to prevent moisture from getting into the device.
- Never completely immerse the handpiece in water.
- Replace the protective cap on the shaver head when you are not using the device.
- Protect the batteries and the product from excessive heat. Remove the battery from the product if it is flat or if you do not intend to use the product for a longer period of time. This will prevent damage caused by leakage.

## Prior to first use

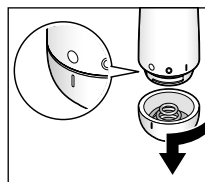

1. Turn the battery compartment cover anti-clockwise as far as it will go, so that the line **I** on the cover points to **●** on the device.
2. Remove the battery compartment cover.

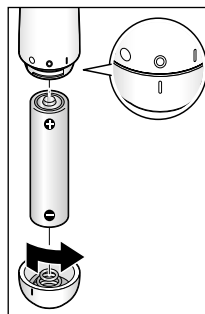

3. Insert the battery provided as illustrated, ensuring that the polarity is correct (+/-).
  4. Place the battery compartment cover onto the battery compartment so that the line **I** on the cover points to **●** and turn it to **O**.
- i** The battery must be changed when the shaver head no longer moves or only moves very slightly.

## Use

- i**
- Always use a mirror when using the device on your face.
  - Clean the device after each use as described in the chapter "Cleaning".

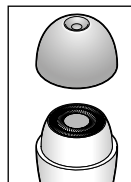

1. Remove the protective cap.

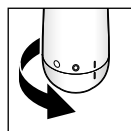

2. To switch the device on, turn the battery compartment cover until the line **I** on the cover points to the line **I** on the device.



Move the shaver head carefully over your skin against the direction of hair growth. To do so, pull your skin taut with your free hand if necessary and move the shaver head **vertically** over the area you wish to shave. Apply only light pressure to avoid injury to the skin and damage to the device.

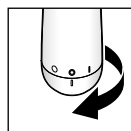

3. To switch the device off, turn the battery compartment cover until the line **I** on the cover points to **O** on the device.

## Cleaning

### NOTICE - material damage

- Never immerse the device completely in water.
- When cleaning the device, the battery compartment cover must be securely closed to prevent moisture from getting into the device.
- Do not use abrasive or caustic cleaning agents or hard brushes, etc. for cleaning.

1. Turn the device off and brush the shaver head using the cleaning brush provided.
2. If necessary, wipe the handpiece with a slightly dampened cloth. Do not under any circumstances clean the handpiece under running water, as otherwise water may get through the housing into the device.

### Cleaning more thoroughly

Remove the shaver head for a more thorough clean:

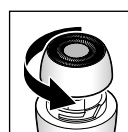

1. Turn the shaver head anti-clockwise as far as it will go and pull it up and off.

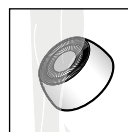

2. Rinse out the shaver head under running water and then allow it to dry completely.

▷ Brush out the inside of the shaver head casing with the supplied cleaning brush as needed.



3. Carefully put the shaver head back on so that it locates in the bayonet catch. Turn it then clockwise all the way. You should feel and hear it click twice into place.

## Problems / solutions

Not working	<ul style="list-style-type: none"> <li>• Battery inserted?</li> <li>• Battery flat?</li> <li>• Battery compartment cover securely closed?</li> </ul>
Hair is not trimmed	<ul style="list-style-type: none"> <li>• Are you holding the shaver head perpendicular to the skin? If held horizontally, the shaver head will not reach the hair.</li> </ul>

## Disposal

This product, its packaging and the battery provided have been manufactured from valuable materials that can be recycled. Recycling reduces the amount of refuse and preserves the environment.

Dispose of the **packaging** at a recycling point that sorts materials by type. Make use of the local facilities provided for collecting paper, cardboard and lightweight packaging.



**Devices, single-use batteries and rechargeable batteries** marked with this symbol must not be disposed of along with household waste!

You are legally obliged to dispose of old devices separately from household waste. Electronic devices contain hazardous substances and, if stored or disposed of improperly, may cause harm to health and the environment. Information about collection points where old devices can be disposed of free of charge is available from your local authorities. Flat single-use and rechargeable batteries must be handed in at a local authority collection point or returned to a battery retailer. Tape off the contacts of lithium single-use/rechargeable batteries prior to disposal.

## Technical specifications

Model:	717 886
Single-use battery:	1x LR6(AA)/1.5 V (ZnMnO <sub>2</sub> )
Operating time (with one battery):	60 minutes
Ambient temperature:	+10 to +40 °C

## Information about the inserted battery

Manufacturer:  
Naccon Power Technology Co. Ltd  
6F, Block A, DongShanGang Industrial Park, Xixiang St.,  
Bao'An District, Shenzhen  
PEOPLE'S REPUBLIC OF CHINA  
www.naccon.com  
Email: aguogo@naccon.com  
Model: LR6 size 1.5V  
Manufacturing date: 2025/06  
Made in: China



www.tchibo.de/instructions  
(Please enter the product number in the box labelled "Bedienungsanleitungssuche" and click on "Suchen".)



**Product number: 717 886**

Made exclusively for:  
Tchibo GmbH, Überseering 18, 22297 Hamburg, Germany