

Thank you for purchasing this product. Please read the instructions carefully before use to ensure safe and satisfactory operation of this product.

## Pack contents

Please check you have all the parts before beginning assembly.

A×1	B×1	C×1	D×1	G×4
			E×1	H×4
			F×1	I×4

## Fitting instructions

Assemble as per the diagram below.

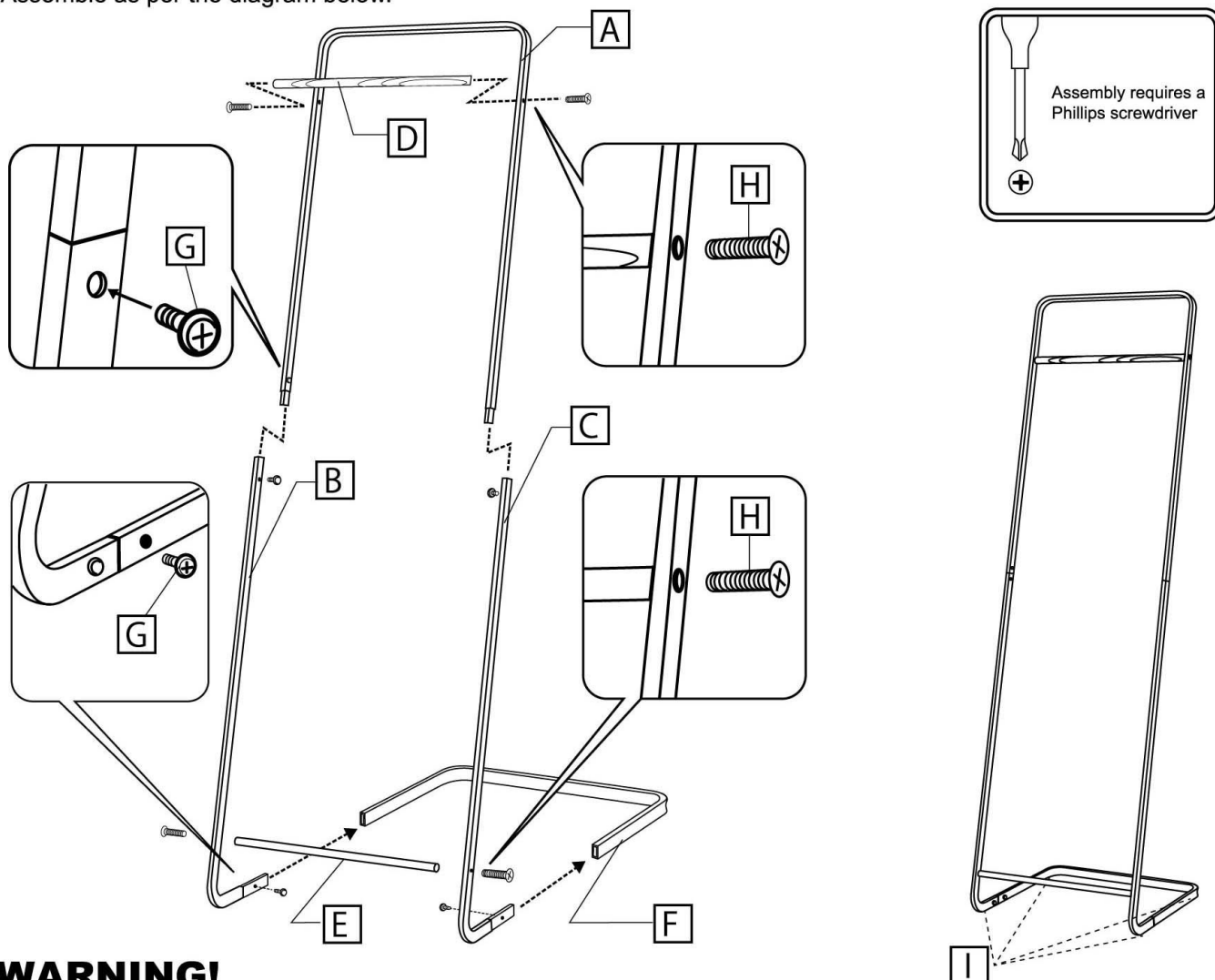

## WARNING!

Max loading weight 5kg

The fittings pack contains small items which should be kept away from young children

## Care and maintenance

Wipe clean with a soft, damp cloth. Do not use scourers or cleaning agents containing abrasives (such as powder cleaners), as this will damage the surface finishes.