

Tchibo Solar LED stone

Instructions for use

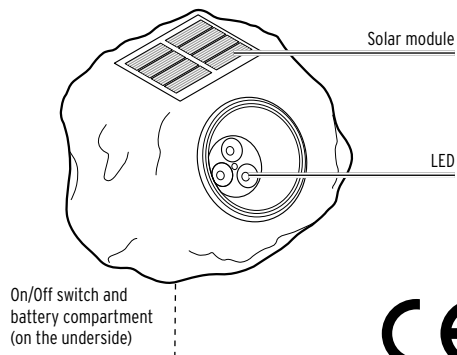

For your safety

Read the safety warnings carefully and only use the product as described in these instructions to avoid accidental injury or damage. Keep these instructions for future reference. If you give this product to another person, remember to also include these instructions.

Intended use

The product is only suitable for decoration and not for lighting whole rooms or outdoor areas. This product is designed for permanent outdoor use. It has been designed for private use and is not suitable for commercial purposes.

Danger to children

- Keep small swallowable parts (e.g. screws) and packaging materials out of the reach of children.
- They pose several risks, including the risk of suffocation/choking!
- The product is not a toy! Keep the light out of the reach of children.

Danger of injury

- Do not operate the product using standard, non-rechargeable batteries. Risk of explosion!
- Rechargeable batteries must not be taken apart, thrown into fire or short-circuited.
- Do not modify and/or deform/heat/dismantle rechargeable batteries. Do not forcibly discharge rechargeable batteries.
- If a rechargeable battery has leaked, avoid contact with skin, eyes and mucous membranes. If necessary, rinse the affected areas with water and consult a doctor immediately.

Material damage

- Do not position the light in hollows or depressions where puddles might form.
- Do not use the product if it shows any visible signs of damage.
- Due to the extremely long service life of the light-emitting diodes (LEDs), it is not necessary to replace them. They cannot and must not be replaced. The LEDs are firmly built into the light. Taking apart the light would damage the light and the LEDs.
- Remove the rechargeable battery from the product, when it is flat or if you do not intend to use the product for a longer period of time. This will help prevent damage caused by leakage.
- Do not make any modifications to the product. Have repairs carried out only by a specialist workshop.
- Do not stick anything to, cover or paint the solar module.

- Make sure that the water outlets on the bottom remain clear so that condensation can escape.
- If you set up the light outdoors, bring it inside if a storm is forecast.
- Do not use any caustic, aggressive or abrasive products for cleaning.
- The product complies with protection type IP44 and is protected against the ingress of solid foreign objects with a diameter larger than 1 mm and splashes of water, but must not be immersed in water. Nor should the product be exposed to direct, heavy rain. The product must be correctly assembled and the battery compartment closed.
- The product is suitable for outdoor use from a minimum temperature of approx. -10 °C. If the temperature falls below this level, store the product inside, otherwise it may become damaged.

Use

Unpacking

- ▷ Carefully take the product out of its packaging and remove all packaging materials.

Switching the light on and off

The On/Off switch and battery compartment are located on the underside of the light.

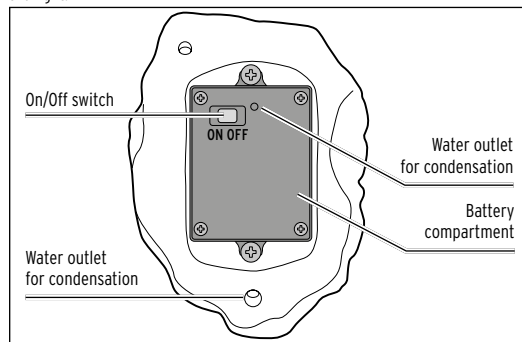

- ▷ Slide the On/Off switch on the underside of the light to **ON** to activate the light.

In this position the light works fully automatically:

- The light switches on at dusk.
- The light switches off at dawn.

- ▷ If you need to deactivate the light, slide the On/Off switch to **OFF**.

The rechargeable battery will continue charging once there is sufficient light.

Choosing a location

The light works independently of any electric power source. However, since it depends on light from the sun, you should consider and observe the following:

- Set up the light in a place where the solar module is exposed to direct sunlight for as long as possible throughout the day.
- Avoid positioning the light in a fully, or mostly shady location (under trees, roof ridges, etc.). Do not place the light on the north side of a building where it would not attract sufficient sunlight during the day.
- The light should not be continuously exposed to other sources of light during the night, for example strong spotlights in a driveway or garage entrance, etc. Keep in mind that many light sources only switch on at night if activated by a time switch or motion sensor.

Charging the rechargeable battery

- The rechargeable battery can only be charged if the light is placed in a sunny spot with the solar module facing upwards.
- Depending on the weather and sun intensity, it can take a few hours for the solar module to fully charge the battery.
- During the winter or after a number of consecutive cloudy days, you may find that the battery is not sufficiently charged. Slide the On/Off switch to **OFF** to turn the light off. The battery will charge even if the light is switched off.

Cleaning

NOTICE - material damage
Do not use any caustic, aggressive or abrasive products for cleaning.

- ▷ If necessary, wipe the light with a slightly damp cloth.

Problems / solutions

The light is not lighting up or is producing only a dim light.

- Is the rechargeable battery not fully charged or worn?
Switch the light off for a few days so that the battery can be fully recharged. The battery cannot be replaced.
- Are the surroundings too bright?
Check whether other sources of light (such as street lights or time or motion sensor-controlled outdoor lights) are shining onto the light. If necessary, change the location.

Performance varies depending on the season.

- This is due to weather conditions and is not a fault. Weather conditions are at their best during the summer, and at their worst in the winter.

Technical specifications

| | |
|-----------------------|-------------------------|
| Model: | 700 014 |
| Power supply | |
| Solar module: | 2 V, 0.27 W |
| Rechargeable battery: | 1x 1.2 V Ni-MH, 600 mAh |
| Protection class: | III |
| Splash protection: | IP44 |
| Bulb: | 3 LEDs |
| Ambient temperature: | -10 to +40 °C |

Disposal

The product, its packaging and the built-in rechargeable battery have been manufactured from valuable materials that can be recycled.

Recycling reduces the amount of refuse and preserves the environment.

Dispose of the **packaging** at a recycling point that sorts materials by type. Make use of the local facilities provided for collecting paper, cardboard and lightweight packaging.



Devices, single-use batteries and rechargeable batteries marked with this symbol must not be disposed of along with household waste!

You are legally obliged to dispose of old devices separately from household waste. Electronic devices contain hazardous substances and, if stored or disposed of improperly, may cause harm to health and the environment. Information about collection points where old devices can be disposed of free of charge is available from your local authorities. Flat single-use and rechargeable batteries must be handed in at a local authority collection point or returned to a battery retailer. Tape off the contacts of lithium single-use/rechargeable batteries prior to disposal.

Removing the rechargeable battery

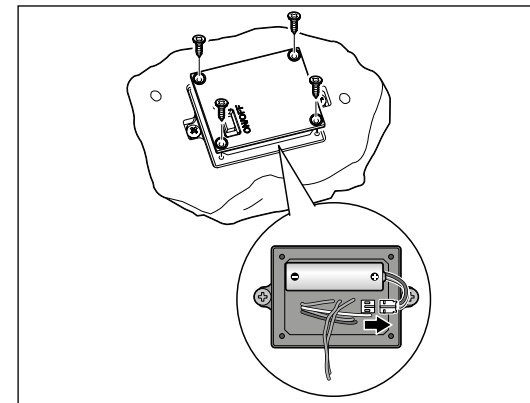

1. Undo the four screws of the battery compartment lid using a Phillips screwdriver.
2. Remove the battery compartment cover carefully, as the battery compartment cover and the battery compartment are connected to each other by a cable.
3. Remove the plug of the rechargeable battery from the circuit boards as illustrated and remove the battery from its holder. Use flat pliers if necessary.
4. Dispose of the rechargeable battery in accordance with the legal requirements.

Product number: 700 014

Made exclusively for:

Tchibo GmbH, Überseering 18, 22297 Hamburg, Germany