

Multifunctional LED light

en Instructions for use

Safety warnings

Read the safety warnings carefully and only use the product as described in these instructions to avoid accidental injury or damage. Keep these instructions for future reference. If you give this product to another person, remember to also include these instructions.

Intended use

The multifunctional LED light is intended for use in dry indoor rooms as a visual aid to help with orientation when it is dark. It is only intended for use in private homes and is not suitable for commercial use.

Danger to children

- Keep the packaging materials out of the reach of children. They pose several risks, including the risk of suffocation!
- The product is not a toy. Children are not aware of the risks involved in handling electronic products incorrectly. Therefore, keep children away from the product.
- Swallowing single-use/rechargeable batteries can be fatal. If a single-use/rechargeable battery has been swallowed, this can lead to severe internal chemical burns and even death within 2 hours. Therefore, keep both new and old single-use/rechargeable batteries and the product out of the reach of children. If you think that a single-use/rechargeable battery has been swallowed or has got into the body in any other way, seek medical advice immediately.

Risk of injury

- Do not look directly into the light for long periods. This could impair eyesight.
- Single-use batteries must not be charged, taken apart, thrown into fire or short-circuited.
- If a battery has leaked, avoid all contact with your skin, eyes and mucous membranes. Rinse the affected areas with water and consult a doctor immediately.

Material damage

- Protect the batteries from intense heat. Remove the batteries from the product when they are flat or if you do not intend to use the product for a prolonged period. This will help prevent damage caused by leakage.
- Always replace all batteries at the same time. Do not mix old and new batteries, different types or brands of batteries, or batteries with different capacities.
- If necessary, clean the battery and device contacts before inserting the batteries. Risk of overheating!
- Ensure correct polarity (+/-) when inserting the batteries.
- Protect the product from dust, moisture, direct sunlight and extreme temperatures. Avoid extreme knocks and impacts.
- The built-in LEDs cannot and must not be replaced.
- Keep cards with magnetic strips, such as credit cards, debit cards, etc. away from the magnetic mounting. The magnetic strips could be damaged. Also keep magnetic storage media and all devices affected by magnetism or which could suffer functional impairment away from the magnetic mounting.
- To enable the magnetic mounting with the tesa® adhesive strip to stick well at the desired location, the surface there must be dry and free of dust, grease, silicone and limescale. In addition, the surface must be solid, smooth and have the necessary load-bearing capacity. Uneven and porous surfaces are not suitable.
- The tesa® adhesive strip is designed for single use only. Constant temperatures over 40 °C reduce the hold of the tesa® adhesive strip. The tesa® adhesive strip is not suitable for temperatures below 15 °C.
- The tesa® adhesive strip only reaches its full hold after approx. 24 hours. Do not load the magnetic mounting before this.

- Mount the magnetic mounting in such a way that nothing will be damaged if the multifunctional LED light should fall down.
- When you remove the magnetic mounting, some adhesive residue may remain on the surface. However, in most cases this can be easily removed from suitable, smooth surfaces by rubbing it off with your finger. Bear in mind that on painted surfaces the colour may be removed as well!
- Do not use any caustic, aggressive or abrasive products for cleaning.

Technical specifications

Model:	726 564
Single-use batteries:	3x LR6 (AA)/1.5 V
Protection class:	III 
Detection angle:	approx. 110°
Sensor range:	approx. 3 m
Light duration:	approx. 30 seconds
Ambient temperature:	+10 to +40 °C
Made exclusively for:	Tchibo GmbH, Überseering 18, 22297 Hamburg, Germany

In the course of product improvements, we reserve the right to make technical and optical modifications to the product.



Inserting / replacing the batteries

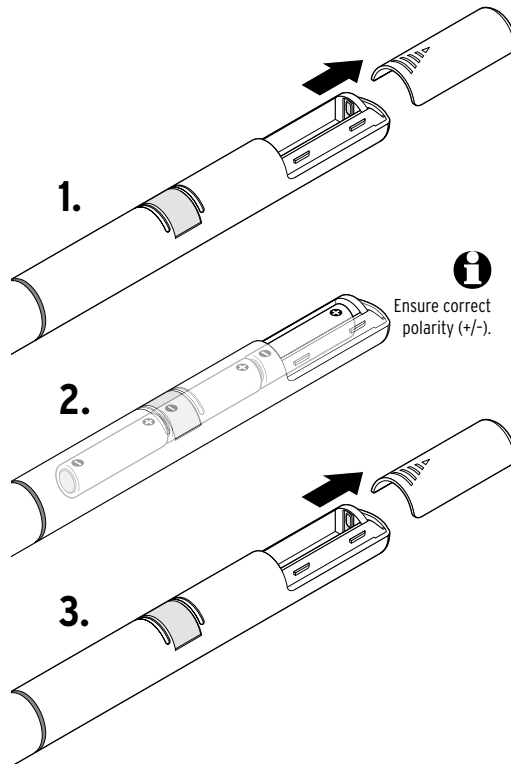

Ensure correct polarity (+/-).

Mounting the LED light

You can attach the magnetic mounting simply with the tesa® adhesive strip or with the screws provided.

Sticking in place

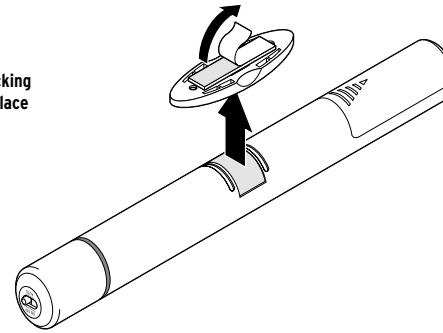

Screwing in place

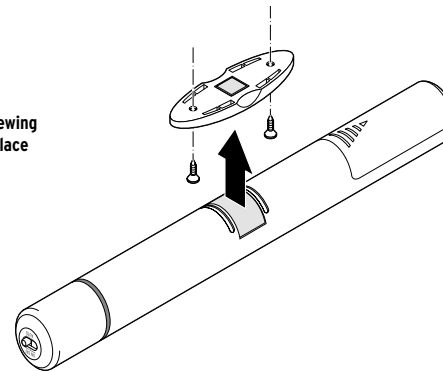

Adjusting the angle of the LED light

You can rotate the multifunctional LED light up to 90°. Adjust the light so that it lights up the selected area well.

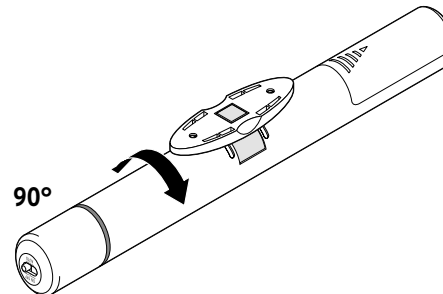

The multifunctional LED light has a motion sensor. You can rotate the motion sensor up to 180°.

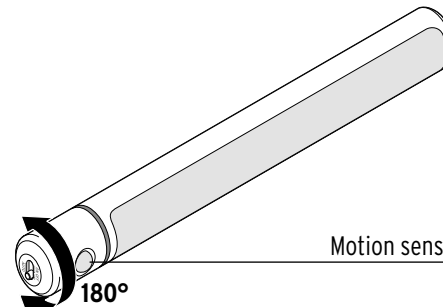

Depending on how far to the front or to the back you have turned the motion sensor, it can detect movement within a 3 m distance and at an angle of 110°, which will then switch the LED light on.

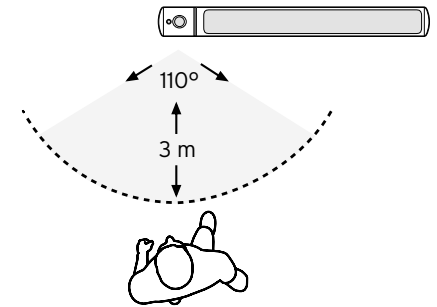

Tip: If you remove the LED light from the magnetic mounting, you can also use it as a torch.

Switching on and off

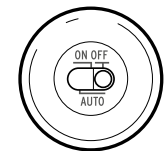

- ON** = The LEDs are permanently switched on.
- AUTO** = The LEDs light up for approx. 30 seconds and then switch off automatically if the motion sensor does not detect any movement. As soon as the motion sensor detects further movement, the LEDs will light up again for approx. 30 seconds.
- OFF** = The LEDs are permanently switched off.

Disposal

The product, its packaging and the supplied batteries have been manufactured from valuable materials that can be recycled. Recycling reduces the amount of refuse and preserves the environment.

Dispose of the **packaging** at a recycling point that sorts materials by type. Make use of the local facilities provided for collecting paper, cardboard and lightweight packaging.

 **Devices, single-use batteries and rechargeable batteries** marked with this symbol must not be disposed of along with household waste!

You are legally obliged to dispose of old devices separately from household waste. Electronic devices contain hazardous substances and, if stored or disposed of improperly, may cause harm to health and the environment. Information about collection points where old devices can be disposed of free of charge is available from your local authorities.

Flat **single-use** and **rechargeable batteries** must be handed in at a local authority collection point or returned to a battery retailer. Tape off the contacts of lithium single-use/rechargeable batteries prior to disposal.



www.tchibo.de/instructions
(Please enter the product number in the box labelled "Bedienungsanleitungssuche" and click on "Suchen".)

Information about the supplied batteries

Manufacturer: CHANGZHOU ANYIDA POWER TECHNOLOGY Co., Ltd., No.1 East Road, Lou Xia Industrial Park, Rulin Town, Jintan District, Changzhou, Jiangsu Province, PEOPLE'S REPUBLIC OF CHINA,
<https://www.anyida-power.com>

Email: zoey@anyida-power.com
Model: Daily-Max LR6 AA size 1.5 V
Manufacturing date: 2025/06
Made in: China