



Rechargeable Solar Lantern with Table Mount

Instructions for use/assembly



At a glance (contents)

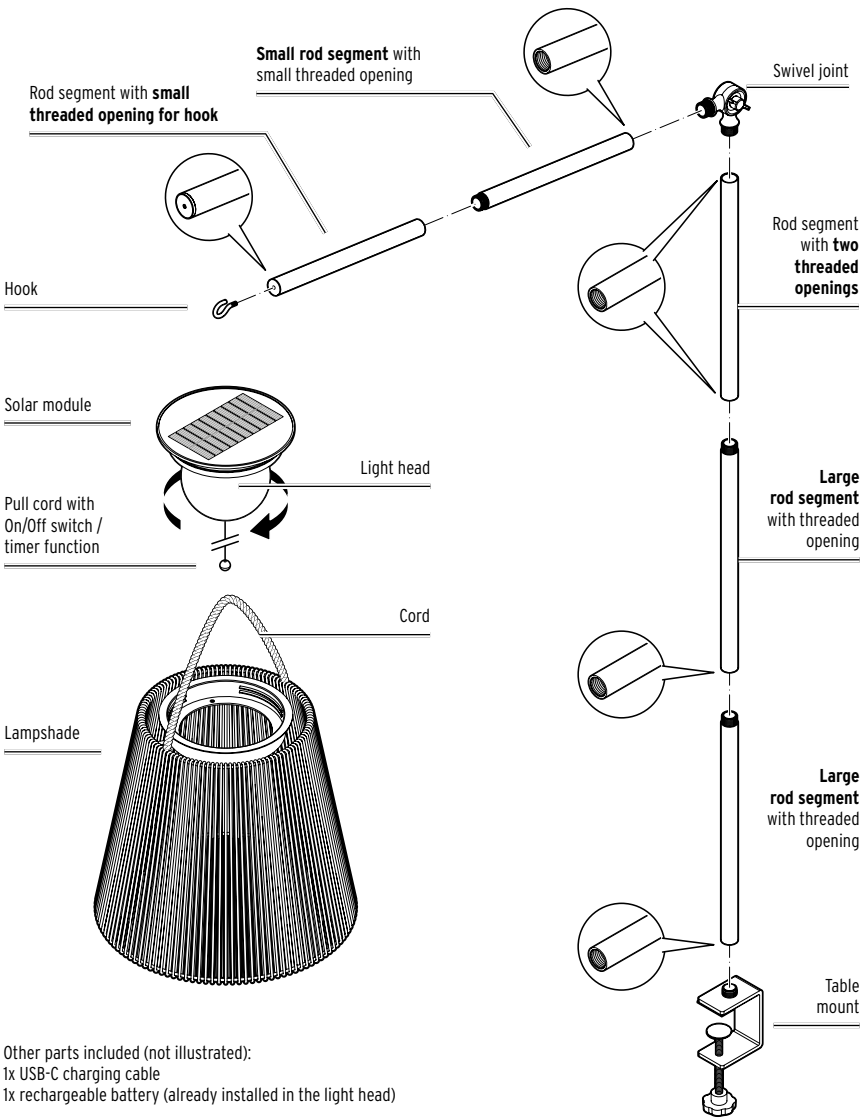

Safety warnings

This product is equipped with safety features. Nevertheless, read the safety warnings carefully and only use the product as described in these instructions to avoid accidental injury or damage. Keep these instructions for future reference. If you give this product to another person, remember to also include these instructions.

The product is only suitable for decoration in private homes and not for lighting whole rooms. The product has been designed for both indoor and outdoor use. It is not suitable for commercial purposes.

- Keep the packaging materials out of the reach of children. They pose several risks, including the risk of suffocation!
- Children are not aware of the risks involved in handling electrical appliances incorrectly. Therefore, never allow children to use electronic appliances unsupervised.

- The product is suitable for outdoor use and, when the port is closed, conforms to protection type IP44. This means that it is protected against contact with tools, wires and foreign objects larger than 1 mm in diameter and splashes of water, such as rain. However, protect it from heavy rain and streams of water. Never use the product under water. This would immediately result in a short circuit.

- Do not use the light or USB-C charging cable if they show any visible signs of damage, or if the light has fallen down.

- A lithium-ion battery is built into the light head.

Warning! Rechargeable lithium batteries can explode ...
... if they are exposed to extreme heat, such as sunlight, fire, etc., or extremely low air pressure during use, storage or transport.

... if they are taken apart, thrown into fire or short-circuited. Do not place any naked flames such as burning candles near the light. The light must be kept away from candles and other naked flames at all times to prevent the spread of fire.

- Do not modify and/or deform/heat/dismantle rechargeable batteries. Do not immerse them in water either.

- There is a risk of explosion if the battery is replaced incorrectly. The battery should be replaced only with an identical or equivalent type. If the rechargeable battery is defective, contact a specialist workshop or our customer care service.

Charging the battery

The rechargeable battery comes in a half-charged state. This is to prevent it from becoming damaged. Fully charge the battery before first use, either via the USB connection to the mains (recommended) or via the solar module.

Charging via the USB connection to the mains

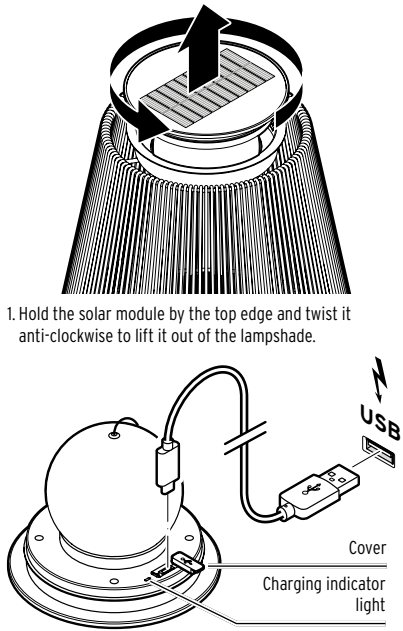

1. Hold the solar module by the top edge and twist it anti-clockwise to lift it out of the lampshade.
2. Open the cover.
3. Connect the supplied USB-C charging cable to the port on the light head and to a suitable USB mains adapter (see "Technical specifications").
4. Insert the mains adapter into a power socket. During charging, the indicator light will light up red. Once the rechargeable battery is fully charged, the indicator light turns green. The usual charging time for charging a flat battery via mains power is approx. 4.5 hours.
5. After charging, unplug the mains adapter from the power socket and disconnect the USB-C charging cable from the port on the light head and from the mains adapter.
6. Replace the cover on the port.

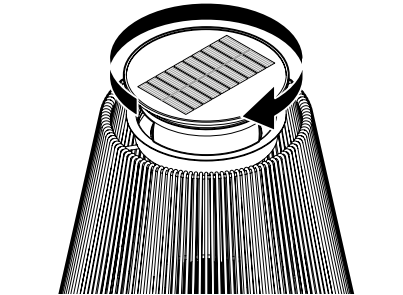

7. Insert the solar module with the light head back into the lampshade and turn it clockwise to secure it.

Information on rechargeable batteries

- To preserve the rechargeable battery's full capacity for as long as possible, you should fully recharge the battery every 2 to 3 months, even if you do not use the product.
- Charge the battery in an environment between +10 and +40 °C.
- The battery will best hold its charge at room temperature. The lower the ambient temperature, the shorter the operating time.

Charging via the solar module

Outdoors, the battery is automatically charged via the solar module in the light head. Consider and observe the following points:

- The solar module must be exposed to as much light as possible, so choose the location for the light with this in mind:
 - Place the light in a sunny location. Choose a site where the light will be exposed to direct sunlight for as long as possible during the day.
 - Avoid positioning the light in a fully, or mainly shady location (beneath trees, roof ridges, etc.). Do not place the light on the north side of a building where there is not sufficient sunlight during the day.
 - The light should not be continuously exposed to other sources of light during the night, e.g. bright spotlights in a driveway or garage entrance, etc. Keep in mind that many light sources only switch on at night if activated by a time-switch or motion sensor.
- Depending on the weather and intensity of the sun, it can take a few hours for the solar module to fully charge the battery.
- During the winter or after a successive number of cloudy days, you may find that the battery is not sufficiently charged. Then leave the light switched off for a few days - the battery will charge even when the light is switched off - or charge the battery via the USB connection to the mains.

Attaching the table mount and hanging the light

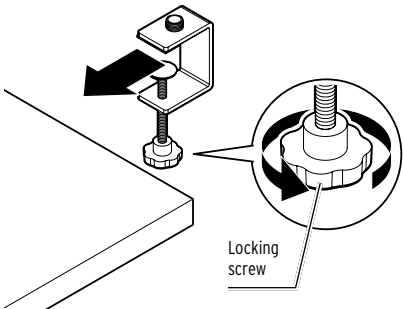

1. Slide the table mount onto the edge of the table as shown. The mount fits table tops up to 6 cm thick.
2. Turn the locking screw clockwise to tighten it until the mount is securely clamped in place.
3. Screw the remaining rod segments together, then screw in the hook as shown under "At a glance (contents)".

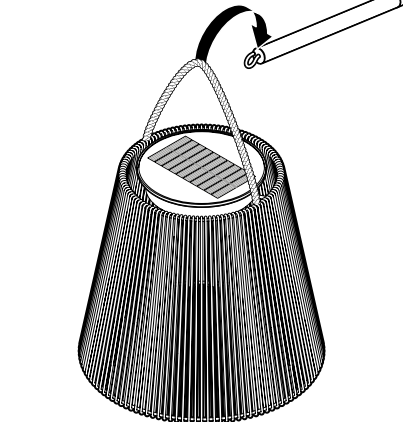

4. Hang the lampshade on the hook.

Activating/deactivating the light / timer function

- Pull the pull cord until you hear and feel it click ...
- ... **1x to activate** the light.
Set to this standard setting, the light will switch on and off fully automatically.
 - The light switches on at dusk.
 - The light switches off at dawn.
 - ... **2x** to turn the light on with the **timer function**.
The light flashes 2x and then lights up continuously for 4 hours when darkness sets in. The light then goes out and only switches on again the next time darkness falls.
 - ... **3x** to **deactivate** the light.
The light is now switched off completely. The rechargeable batteries will continue charging once there is sufficient light.

Cleaning

NOTICE - material damage
Do not use any caustic, aggressive or abrasive products for cleaning.

1. Remove dust from the woven lampshade using a duster.
2. Wipe all other surfaces with a soft, slightly damp cloth if necessary.
3. Then rub all parts completely dry with a soft, dry cloth.

Problems / solutions

The light is not lighting up or is producing only a dim light.

- Are the surroundings too bright?
Check whether other sources of light (such as street lights or time or motion sensor-controlled outdoor lights) are shining onto the solar module. If necessary, change the location of the light.
- Is the solar module provided with sufficient sunlight?
If necessary, change the location of the light.
- Is the rechargeable battery fully charged?
Leave the light switched off for a few days to allow the battery to charge sufficiently, or charge the battery via the USB connection to the mains.

The LEDs are faulty.

- The LEDs are firmly built in and cannot be replaced.

The lighting duration varies depending on the season (when the battery is charged via the solar module).

- The lighting duration depends on the intensity and duration of sunlight and therefore varies according to the season. On long summer days, the battery reaches its maximum charge for a lighting duration of up to 20 hours. In winter, this is naturally lower due to shorter and often cloudier days. This is a normal characteristic of solar-powered operation and does not indicate a fault.

Technical specifications

Model:	730 182
Power supply:	
Solar module:	5 V / 300 mA
Rechargeable battery:	1x lithium-ion battery, 3.7 V 2500 mAh (the symbol indicates direct current)
	Watt-hour rating: 9.25 Wh
Input:	5 V 2 A (The symbol indicates direct current)
Charging time (via USB connection):	approx. 4.5 hours
Light duration (with fully charged battery):	approx. 20 hours
IP code:	IP44
Protection class:	III
Light source:	12 LEDs
Ambient temperature:	-10 to +40 °C
Made exclusively for:	Tchibo GmbH, Überseering 18, 22297 Hamburg, Germany

Disposal

The product, its packaging and the built-in rechargeable battery have been manufactured from valuable materials that can be recycled. Recycling reduces the amount of refuse and preserves the environment. Dispose of the packaging at a recycling point that sorts materials by type. Make use of the local facilities provided for collecting paper, cardboard and lightweight packaging.



Appliances, single-use batteries and rechargeable batteries marked with this symbol must not be disposed of along with household waste! You are legally obliged to dispose of old appliances separately from household waste. Electronic appliances contain hazardous substances and, if stored or disposed of improperly, may cause harm to health and the environment. Information about collection points where old appliances can be disposed of free of charge is available from your local authorities. Flat single-use and rechargeable batteries must be handed in at a local authority collection point or returned to a battery retailer. Tape off the contacts of lithium single-use/rechargeable batteries prior to disposal.

For instructions on how to remove the rechargeable battery, see "Removing / replacing the rechargeable battery".

Removing / replacing the rechargeable battery

The rechargeable battery is designed for long-term operation. However, after a long period of use it may need to be replaced. Rechargeable batteries are subject to standard wear and tear, and performance can diminish.

1. Switch off the light.
2. Turn the solar module with the light head anti-clockwise to remove it from the lampshade.

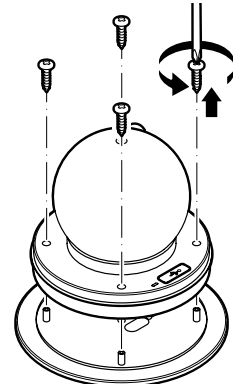

3. Loosen the 4 screws on the light head with a Phillips screwdriver and carefully remove the light head. Be careful not to rip off any cables!

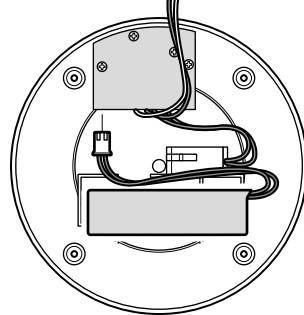

4. Remove the plug of the interconnecting cable from the socket on the circuit board as illustrated and remove the rechargeable battery from its holder.
5. Insert the plug of the new battery. You can order a new rechargeable battery by contacting our customer care service (see enclosed Warranty).
6. Place the light head back onto the solar module and tighten the screws.
7. Insert the solar module with the light head back into the lampshade and turn it clockwise to secure it.

Product number: 730 182